



# PRODUCE

## COLLECTION

 **DISPLAYS**  
**Cayuga**

















## DEPARTMENT: PRODUCE

**The produce department is the single greatest determiner of customer loyalty. More than just showcasing fresh product, the produce area needs to have a fresh overall energy too, with plentiful displays and great range of product.**

**Don't let the product - rich center areas or your store go under - utilized. Self-contained plug and play refrigerated displays provide the flexibility to quickly add appealing display options creating visible interest and maximum interest.**

Cayuga Displays has an extensive line of display possibilities to highlight the produce itself, as well as to cross-merchandise related products, like dried fruits, sauces and nuts. We offer great options for getting more refrigeration on your floor in order to build your customers' shopping experiences and get more product noticed.

And when you work with Cayuga Displays, you can always be confident we'll help you to select the right product and options, so that you have the food presentation that is certain to elevate your customers' experience and enhance your brand - beautifully.

*"Longos is pleased to support Cayuga Displays. Your team's quick service/turnaround for projects has helped us with our millwork for bakery and floral in past projects. More recently your team has come up with some cost effective refrigeration solutions for our bakery and produce."*

Paul Collette,  
Longo's Support Center  
Project Manager Real Estate  
and Construction

*"Cayuga has always provided us with sensible and reliable options and have always exceeded our expectations in customer service."*

Neil Forth,  
Neelands Refrigeration  
Sales

# Table of Contents

## Multi-Tier Island

Multi-Tier Double Sided Table - Flat Deck	9
Multi-Tier Double Sided Table - Angled Deck	10
End Cap Table - Small Depth	11
End Cap Table - Large Depth	12
Banana Riser	13

## Multi-Tier Table

Double Sided Multi-Tier Table	15
Single Sided Multi-Tier Table	16

## Island Produce Tables

Table With Open Base Storage	18
End Cap Table With Open Base Storage	19

## Single-Level Self-Service Display - 42"H

Single-Level Self-Service Display - 42"H Renderings	22
---	----

## Two-Level Self-Service Display - 49"H

Two-Level Self-Service Display - 49"H Renderings	26
--	----

## Three-Level Self-Service Display - 54"H

Three-Level Self-Service Display - 54"H Renderings	30
--	----

## Market Bin

Market Bin	35
Market Bin w/ Base Merchandising	36
Market Ice Bin	37
Market Ice Bin w/ Base Merchandising	38
Wing Table - 3 Open Sides	39
Closed Wing Table	40

## Critical Temperature Single POD Mobile Merchandiser

## Critical Temperature 2-POD Mobile Merchandiser

## Critical Temperature Mobile Merchandiser Accessories

## Three-Level Upright Self-Service Display - 53"H

Three-Level Upright Self-Service Display - 53"H Renderings	52
--	----

## Four-Level Upright Self-Service Display - 63"H

54

# Table of Contents Continued

Four-Level Upright Self-Service Display - 63”H Renderings	56
Single-Level Self-Service Display - 42”H	58
Single-Level Self-Service Display - 42”H Renderings	60
Two-Level Self-Service Display - 49”H	62
Two-Level Self-Service Display - 49”H Renderings	64
Three-Level Self-Service Display - 54”H	66
Three-Level Self-Service Display - 54”H Renderings	68
Refrigerated Display Accessories	70
Narrow Multi-Shelf Table	74
Accessories	
Bag Holder	76
Produce Tray	77
Produce Tray w/Lip	78
Anti-Bruise Foam Mattnng - Roll	79
Clamp on Sign Frame	80
Things to Consider	82
Tips to Combat Condensation	84
Finishes	
Laminate	86
Painted Metal	88
Wood Stains	89
How to Order	90

# MULTI-TIER ISLAND REFER TO PAGES 6 - 10



*Finish: Select Cherry*

13' 5"L Flat Deck Single Level shown  
(refer to pages 6 & 8)



*Finish: Danish Walnut*

7' 10 ½"L Flat Deck Multit-Level shown  
(refer to pages 6 & 8)



*Finish: Oiled Cherry*

13' 5"L Angled Deck Single Level shown  
(refer to pages 7 & 8)



*Finish: Weathered Wood*

7' 10 ½"L Angled Deck Multit-Level shown  
(refer to pages 7 & 8)

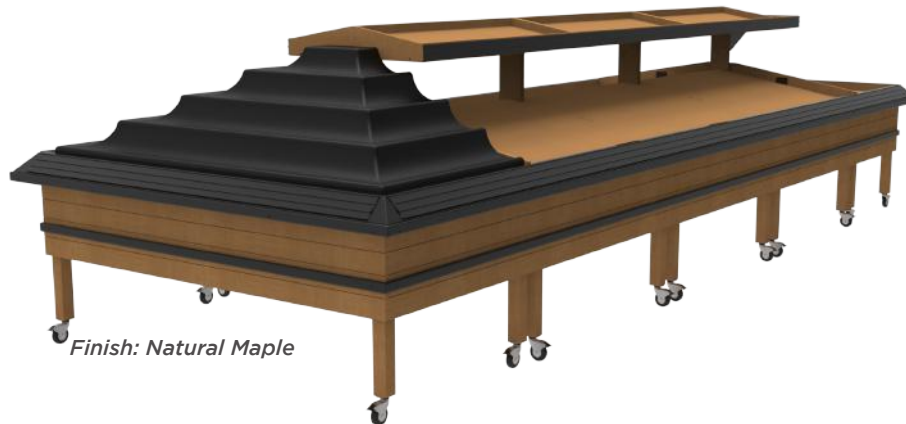

*Finish: Natural Maple*

17' 11"L Angled Deck Multit-Level shown  
(refer to pages 7 - 10)

## Applications

- The multi-tier island tables are designed to be easily installed into an island setup, either with or without the upper shelf
- Both upper and lower table decks have sign track for clearly visible price tags
- Heavy duty locking casters, corner caps and bumper
- Centre tables come in either angled deck or flat deck



# MULTI-TIER DOUBLE SIDED TABLE FLAT DECK



Clear finish shown



Select Cherry finish shown. Other finishes available - see chart.

MODEL	DESCRIPTION	LENGTH	DEPTH	HEIGHT
TBFD-022-01B	Multi-Tier Double Sided Flat Deck - 48"	47 1/2"	79"	52"
TBFD-022-01C	Double Sided Flat Deck - 48"	47 1/2"	79"	32"
SHCM-014-14.25-29.50	Mounted Shelf	29 1/2"	14 1/4"	3"

## FEATURES:

- Birch/maple plywood, MDF and solid maple construction
- 3 Track sign holder
- Locking casters
- 1 1/2" ABS bumper

## OPTIONS:

- Mounted side shelf
- Refer to Wood Stains Finishes

Note: Information and specifications may change due to engineering improvements.

Optional Mounted Shelf

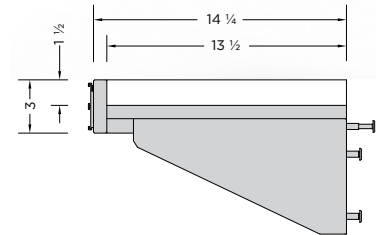
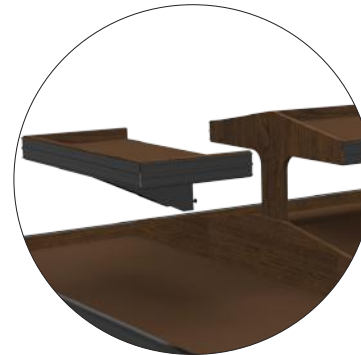

SHCM-014-14.25-29.50

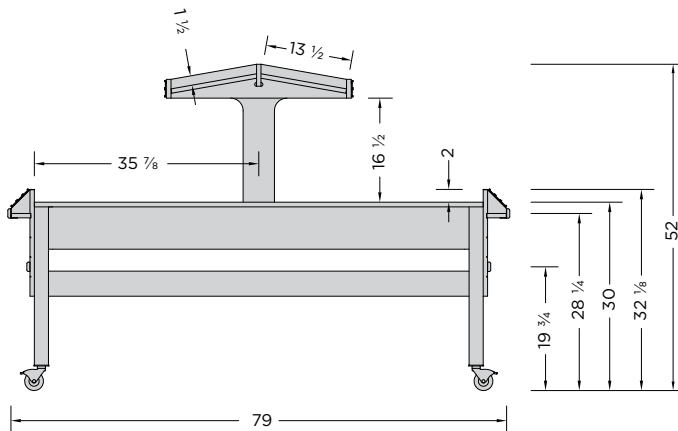

TBFD-022-01B

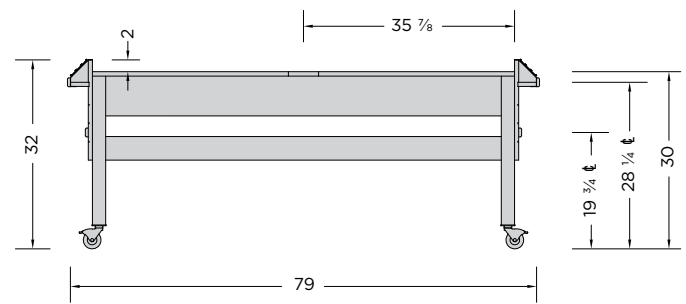

TBFD-022-01C



# MULTI-TIER DOUBLE SIDED TABLE ANGLED DECK

Clear finish shown



Oiled Cherry finish  
shown. Other finishes  
available - see chart.

MODEL	DESCRIPTION	LENGTH	DEPTH	HEIGHT
TBFD-023-01B	Multi-Tier Double Sided Angled Deck - 48"	47 ½"	79"	52"
TBFD-023-01C	Double Sided Angled Deck - 48"	47 ½"	79"	32"
SHCM-014-14.25-29.50	Mounted Shelf	29 ½"	14 ¼"	3"

## FEATURES:

- Birch/maple plywood, MDF and solid maple construction
- 3 Track sign holder
- Locking casters
- 1 ½" ABS bumper

## OPTIONS:

- Mounted side shelf
- Refer to Wood Stains Finishes

Note: Information and specifications may change due to engineering improvements.

## Optional Mounted Shelf

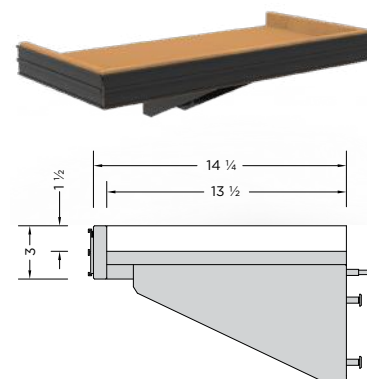
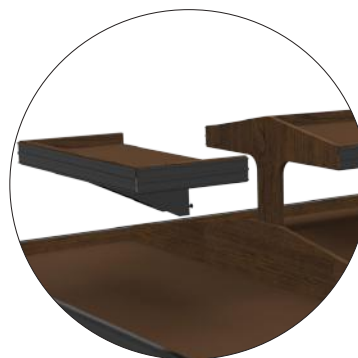

SHCM-014-14.25-29.50

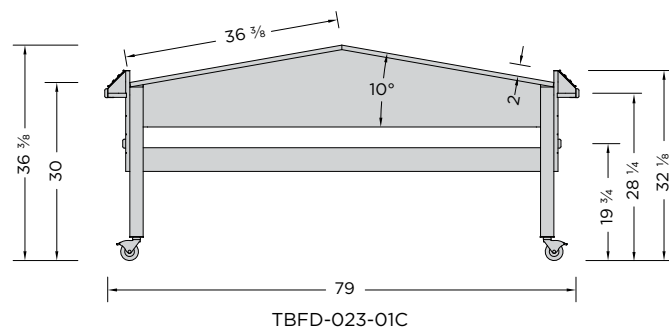
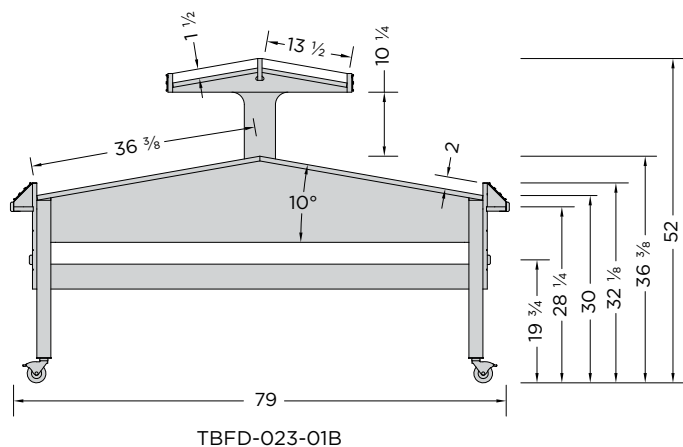



# END CAP TABLE SMALL DEPTH



MODEL	DESCRIPTION	LENGTH	DEPTH	HEIGHT
TBIE-053-01B	End Cap Table - Small	77 1/8"	33"	32 1/8"
TBIE-053-01C	End Cap Table w/ Rear Product Stop - Small	77 1/8"	33"	38 1/8"

## FEATURES:

- Birch/maple plywood, MDF and solid maple construction
- Protective corner guards
- 3 Track sign holder
- Locking casters
- 1 1/2" ABS bumper

## OPTIONS:

- Refer to Wood Stains Finishes

Note: Information and specifications may change due to engineering improvements.

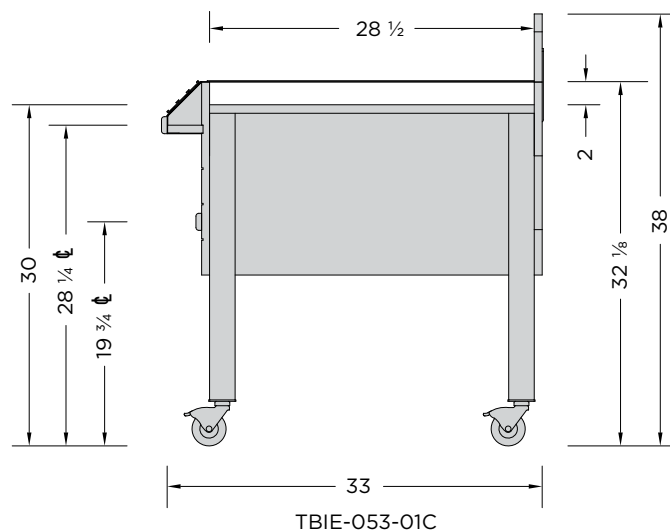
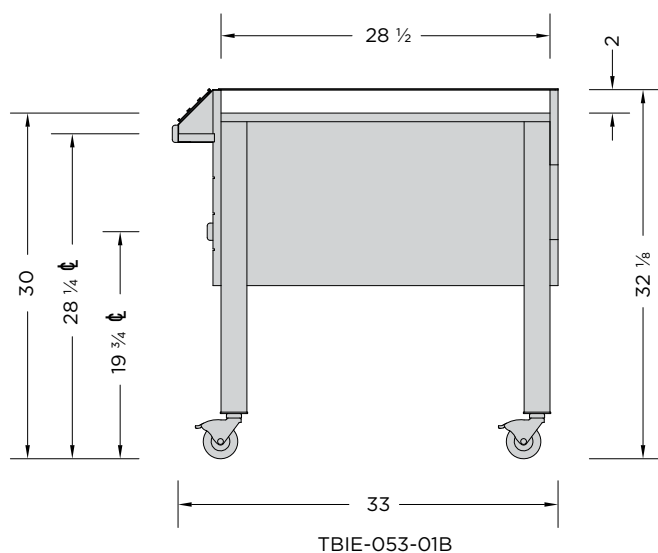



# END CAP TABLE LARGE DEPTH

Clear finish shown



Weathered Wood  
finish shown. Other  
finishes available -  
see chart.

MODEL	DESCRIPTION	LENGTH	DEPTH	HEIGHT
TBIE-070-01B	End Cap Table - Large	79"	39 ½"	32 ⅛"
TBIE-070-01C	End Cap Table w/ Rear Product Stop - Large	79"	39 ½"	38 ⅛"

## FEATURES:

- Birch/maple plywood, MDF and solid maple construction
- Protective corner guards
- 3 Track sign holder
- Locking casters
- 1 ½" ABS bumper

## OPTIONS:

- Banana Riser
- Refer to Wood Stains Finishes

Note: Information and specifications may change due to engineering improvements.

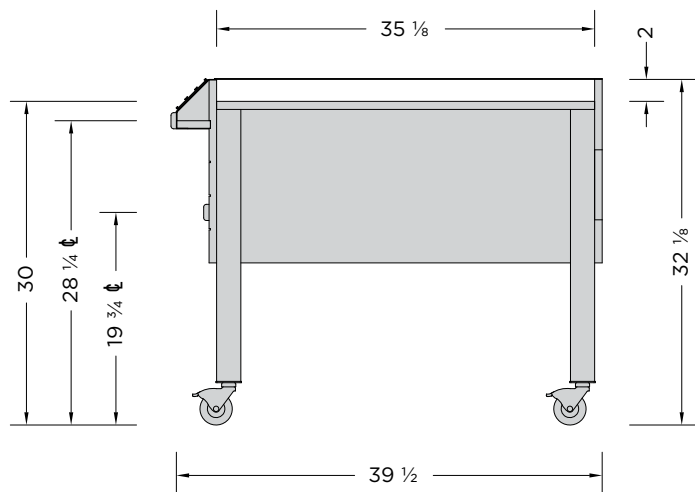

TBIE-070-01B

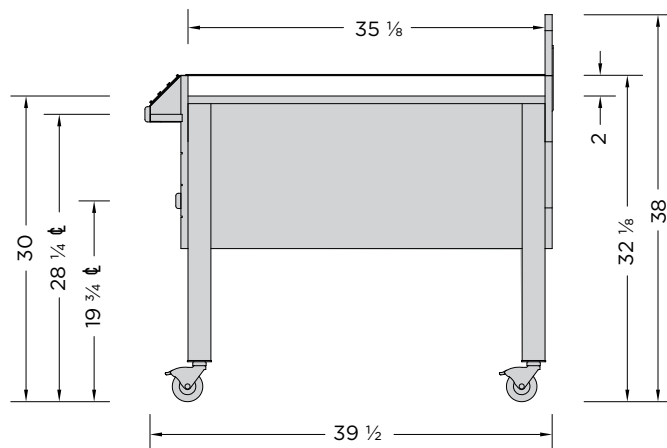

TBIE-070-01C



# BANANA RISER



MODEL	DESCRIPTION	LENGTH	DEPTH	HEIGHT
ACRI-049-01A	Banana Riser	70"	34 ¼"	18 ¾"

- FEATURES:**
- Black ABS construction

Note: Information and specifications may change due to engineering improvements.

**\*\* BANANA RISER ONLY WORKS WITH TABLES TBIE-070-01B OR TBIE-070-01C \*\***



*TBIE-070-01B w/Banana Riser shown.*

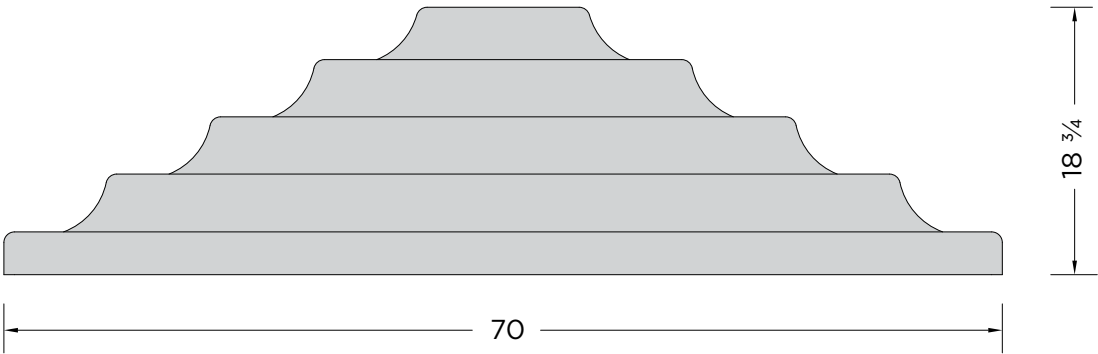

ACRI-049-01A

# MULTI-TIER TABLE

*Finish: Natural Maple*

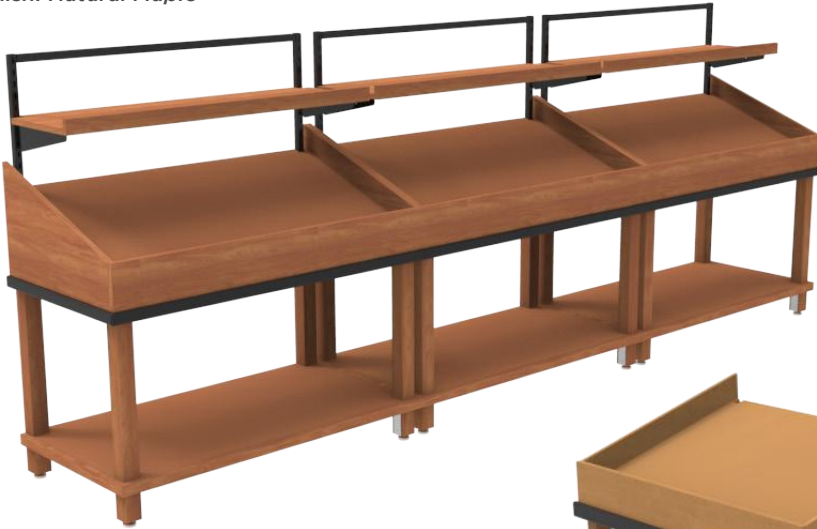

12' L Multi-Tier Single Sided Table shown  
(refer to page 13)

*Finish: Natural Maple*

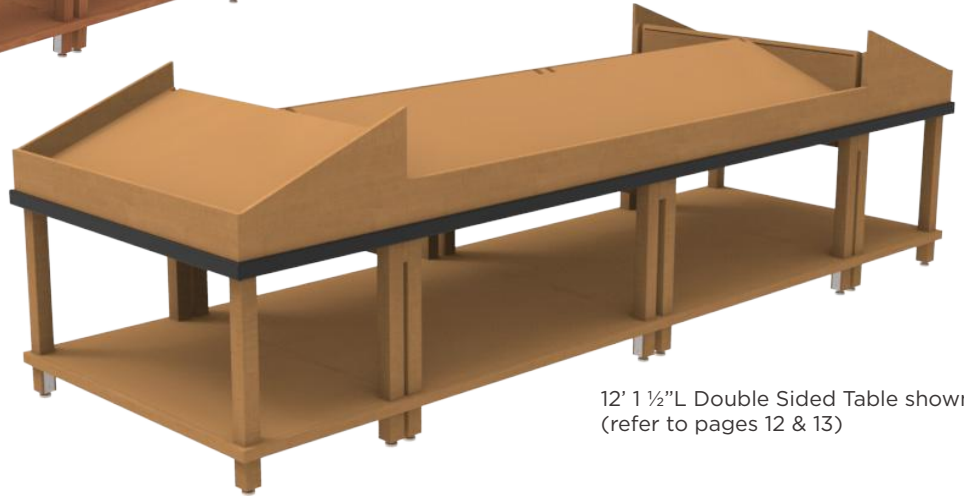

12' 1 1/2' L Double Sided Table shown  
(refer to pages 12 & 13)



12' 1 1/2' L Multi-Tier Double Sided Table shown  
(refer to pages 12 & 13)

*Finish: Weathered Wood*

## Applications

- The multi-tier table is designed to be easily installed into an island or single sided set up, with optional adjustable upper shelf/metal frame and base merchandising
- Main table deck sits at a fixed 20° angle
- ABS bumper and levelers
- Protective corner guards and data strip available upon request



# DOUBLE SIDED MULTI-TIER TABLE



MODEL	DESCRIPTION	LENGTH	DEPTH	HEIGHT
TBFD-001-01D	Double Sided Multi-Tier Table- 48"	48"	48"	38 ¼"
TBFD-001-01B	Double Sided Multi-Tier Table w/ Shelf- 48"	48"	48"	54 7/8"

## FEATURES:

- Birch/maple plywood, MDF and solid maple construction
- Lower merchandising shelf
- Adjustable nylon levelers
- 1 ½" ABS bumper

## OPTIONS:

- Adjustable 14" deep plywood shelf on metal brackets w/ metal uprights (Angle: 0°, 15° or 30°)
- Bag holder, signage, data strips, product stops and product dividers also available
- Refer to Wood Stains Finishes

Note: Information and specifications may change due to engineering improvements.

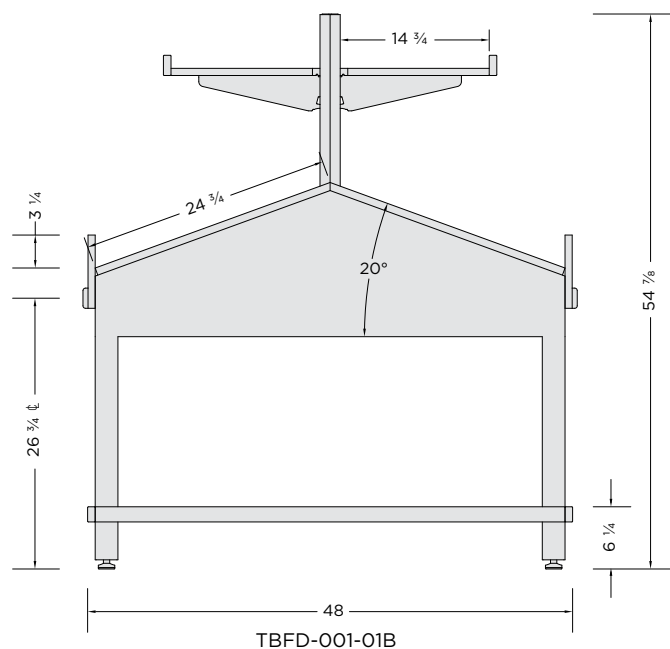
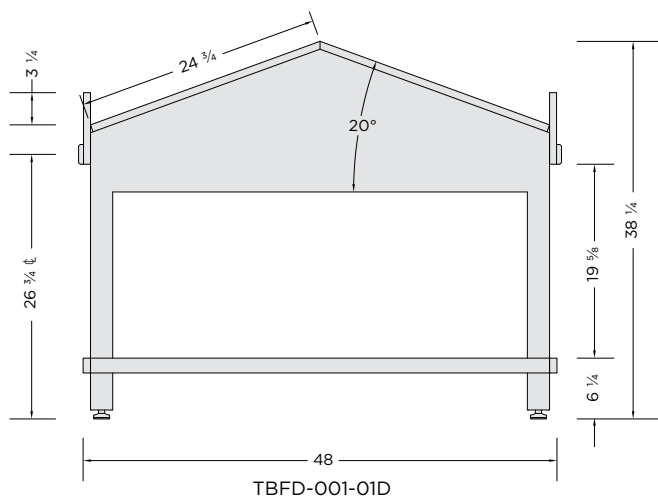

# SINGLE SIDED MULTI-TIER TABLE



Clear finish shown



Weathered Wood finish shown. Other finishes available - see chart.

MODEL	DESCRIPTION	LENGTH	DEPTH	HEIGHT
TBIE-003-01L	Single Sided Multi-Tier Table	48"	24 $\frac{3}{4}$ "	41 $\frac{3}{4}$ "
TBIE-003-01E	Single Sided Multi-Tier Table w/ Shelf	48"	24 $\frac{3}{4}$ "	54 $\frac{7}{8}$ "

## FEATURES:

- Birch/maple plywood, MDF and solid maple construction
- Lower merchandising shelf
- Adjustable nylon levelers
- 1 1/2" ABS bumper

## OPTIONS:

- Adjustable 14" deep plywood shelf on metal brackets w/ metal uprights (Angle: 0°, 15° or 30°)
- Bag holder, signage, data strips, product stops and product dividers also available
- Bag holder and signage also available
- Refer to Wood Stains Finishes

Note: Information and specifications may change due to engineering improvements.

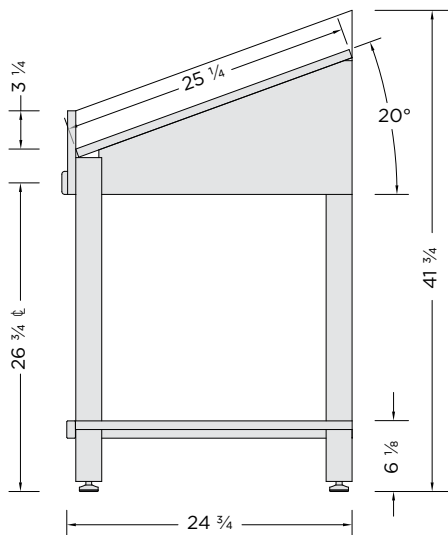

TBIE-003-01L

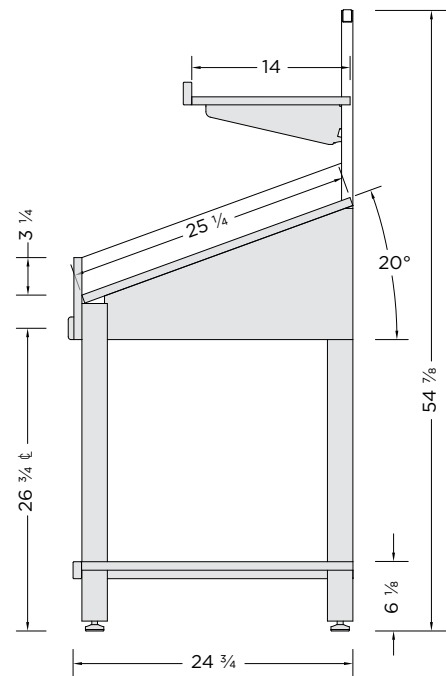

TBIE-003-01E



# ISLAND PRODUCE TABLES

11' 11 1/2"L Island Tables shown  
(refer to pages 15 & 16)



*Finish: Select Cherry*

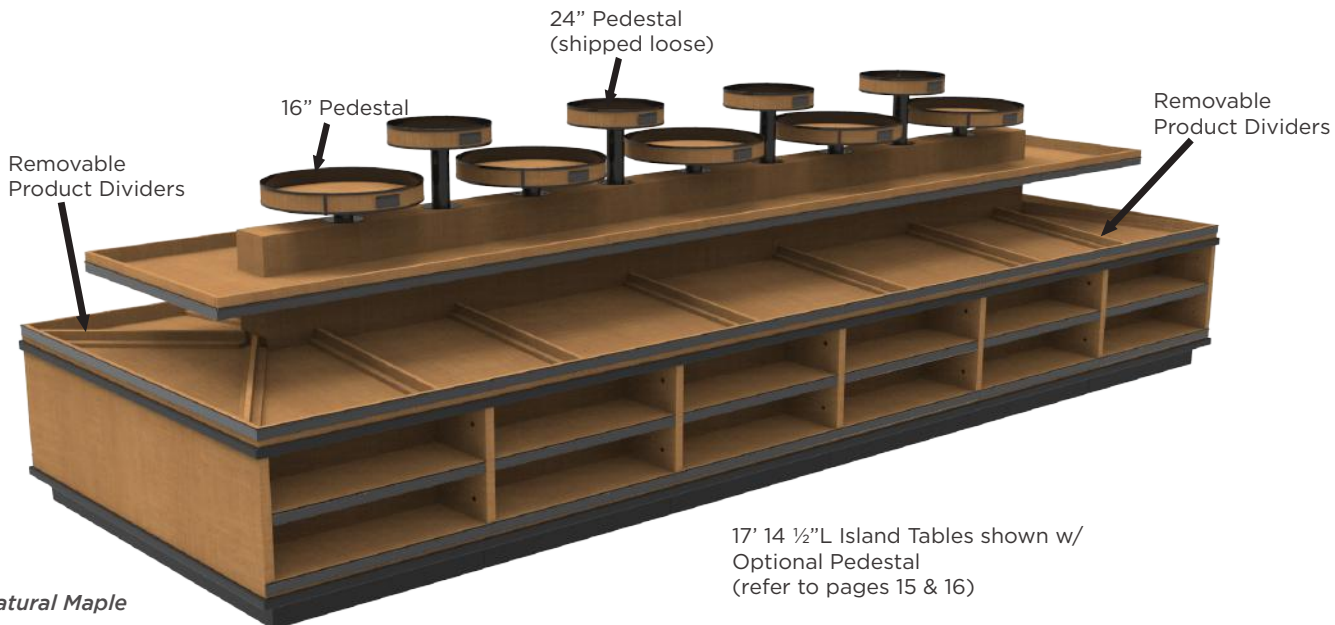

*Finish: Natural Maple*

## Applications

- Island produce tables are designed to easily line up into run as well as provide a seamless look
- Units are easily connected with furniture supplied bolts. Center units come with the 16" pedestal attached to the unit while the 24" pedestal is shipped loose and requires fastenning upon assemble of island (fasteners supplied)
- Center divider
- Data strip, ABS bumper and levelers

# TABLE WITH OPEN BASE STORAGE

Clear finish shown



Danish Walnut finish shown. Other finishes available - see chart.



MODEL	DESCRIPTION	LENGTH	DEPTH	HEIGHT
TBFD-021-02B	Table w/ Open Base Storage	72"	33 1/2"	45 1/2"

## FEATURES:

- Birch/maple plywood and solid maple construction
- Base merchandising with adjustable shelf on shelf pins
- Data strip and product stops
- Levelers
- 1 1/2" ABS bumper
- Designed to work with TBIE-069-01B

## OPTIONS:

- Refer to Wood Stains Finishes

Note: Information and specifications may change due to engineering improvements.

## OPTIONAL 16" & 24" PEDESTALS

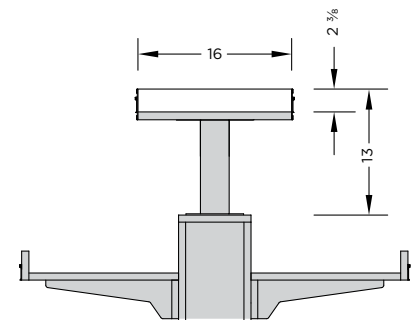

### ACRI-061-02B

16" Pedestal (shipped fastened to top ledge)

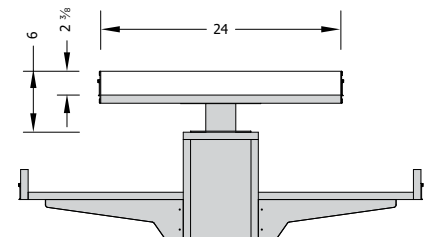

### ACRI-061-01A

24" Pedestal (shipped loose)  
With locator holes, Allen key, and furniture bolts, assembly is simple. No other equipment is needed.)

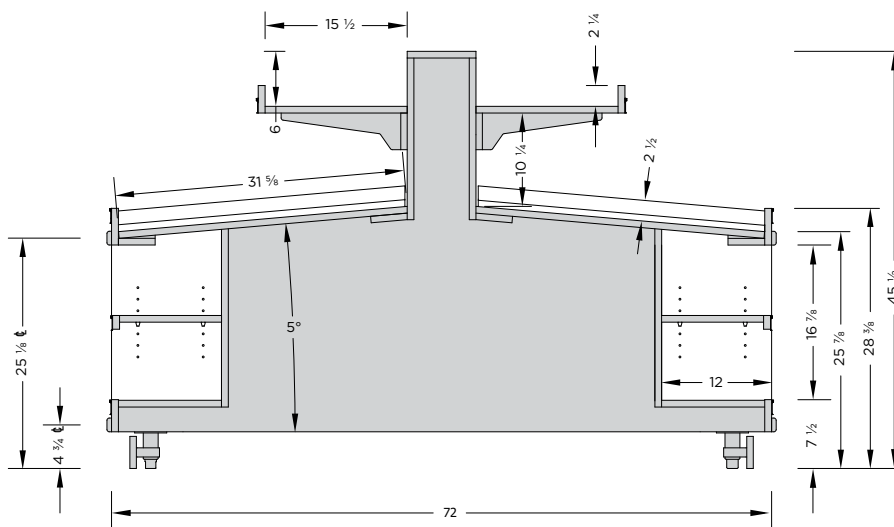

TBFD-021-02B



# END CAP TABLE WITH OPEN BASE STORAGE



Removable  
Product Dividers

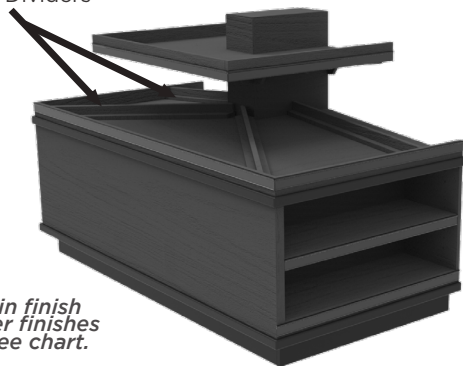

*Iron Mountain finish  
shown. Other finishes  
available - see chart.*

MODEL	DESCRIPTION	LENGTH	DEPTH	HEIGHT
TBIE-069-01B	End Cap Table w/ Open Base Storage	72"	36 ¼"	45 ½"

## FEATURES:

- Birch/maple plywood and solid maple construction
- Base merchandising with adjustable shelf on shelf pins
- Data strip and product stops
- Levelers
- 1 ½" ABS bumper
- Designed to work with TBFD-021-02B

## OPTIONS:

- Refer to Wood Stains Finishes

Note: Information and specifications may change due to engineering improvements.

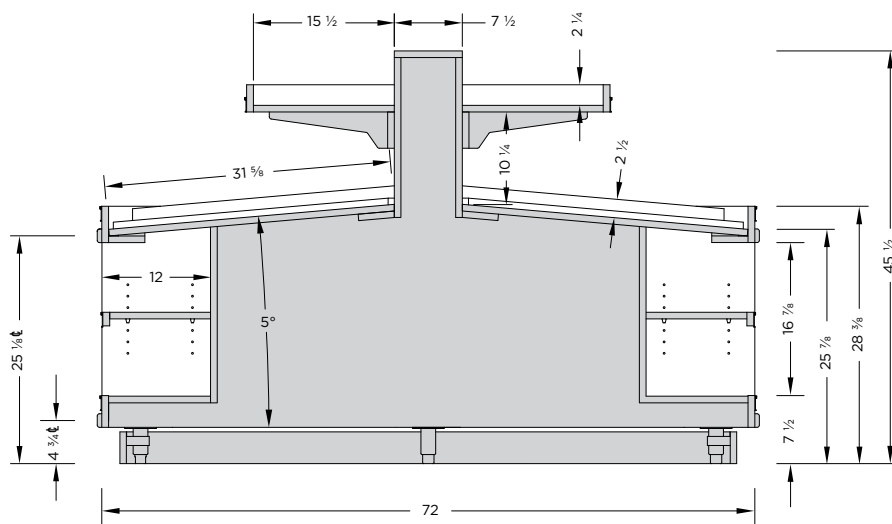

TBIE-069-01B

# SINGLE-LEVEL SELF-SERVICE DISPLAY - 42"H

 REFRIGERATED

*Solid end panels shown*



*End panels with glass shown*

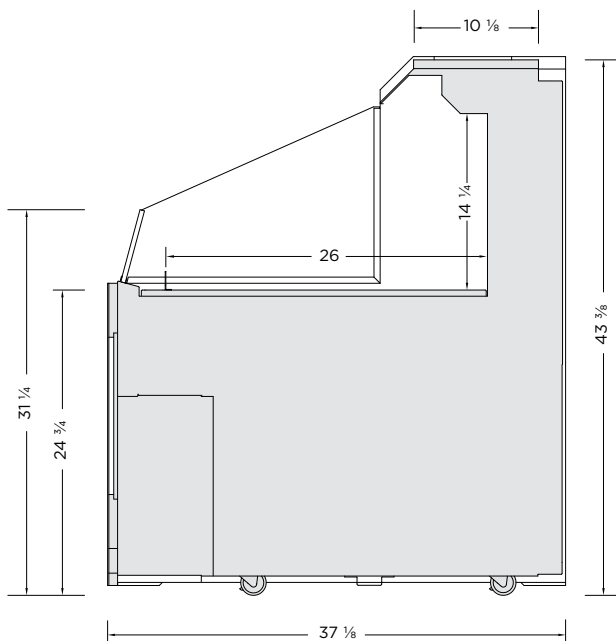

MODEL	LENGTH
FGD-24-42	26 1/4"
FGD-38-42	40 1/4"
FGD-48-42	49 7/8"
FGD-57-42	59 3/8"
FGD-76-42	78 1/2"
FGD-96-42	97 5/8"

## FEATURES:

- Brushed Stainless steel internal cabinet construction
- Many exterior natural wood finishes available
- 3 interior finish options: textured powdercoat black, white and brushed stainless steel
- Other custom options are offered. Refer to the options schedule on the next page
- A LED light strip is mounted on the top ledge of the display area. Various light intensities/spectrums are available
- Designed to maintain the critical temperature of the products within the display at a range of 38-41°F (3-5°C) with an ambient atmosphere of 75°F (24°C)/55% humidity
- ETL electrical certification and NSF-7 standards
- New R-513A (non-ozone depleting, low global warming potential) refrigerant used in the self-contained refrigeration system
- The refrigeration system is designed to pull fresh air from the front base of the display and vent through an integrated rear vent. The unique rear vent allows the display to be backed up against a wall or other displays/obstructions
- Remote refrigeration available. Contact Cayuga Displays for details

## SUGGESTED APPLICATIONS:

 Cafe

 Restaurant

 Bakery

 Butcher Shop

 Deli

 Produce

Note: Information and specifications may change due to engineering improvements.





# SINGLE-LEVEL SELF-SERVICE DISPLAY - 42"H

REFRIGERATED

TECHNICAL SPECS				
MODEL	LENGTH	VOLTS	AMPS	NEMA
FGD-24-42	26 ¼"	115	11.8	5-15P
FGD-38-42	40 ¼"	115	11.9	5-15P
FGD-48-42	49 ¾"	115	12.0	5-15P
FGD-57-42	59 ¾"	115/230	9.3	L14-20P
FGD-76-42	78 ½"	115/230	12.1	L14-20P
FGD-96-42	97 ¾"	115/230	12.5	L14-20P

## STANDARD FEATURES:

- 3 interior finishes options: textured powdercoat black, white and brushed stainless steel
- Standard natural wood exterior panels
- Solid end panels with black or white interior finish
- A LED light strip is mounted on the top ledge of the display area
- The refrigeration system is designed to pull fresh air from the front base of the display and vent through an integrated rear vent. The unique rear vent allows the display to be backed up against a wall or other displays/obstructions

## CUSTOM OPTIONS:

EXTERIOR FINISHES	
Oak Veneer Plywood	
- Vertical grain direction	
Birch/Maple Veneer Plywood	
- Vertical grain direction	
Clear Finish applied to veneer	
Stain Finish Choice _____	
1" black McCue impact bumper strip applied to the front of the display	
Other McCue impact bumper strip colors Available upon request	

## END PANELS

Interior laminate the same as exterior	
Brushed Stainless Steel interior	
Mirrored interior	
Tempered glass end panels	
Mirrored glass panels	
1" black McCue impact bumper strip applied to the front of the display	
Other McCue impact bumper strip colors Available upon request	

## MISCELLANEOUS OPTIONS

2 ½" H x 14"D Stepped Riser	
Perforated inlay panel for canted display	
Roll-down thermal night curtain	
Heavy duty lockable casters	
Bolt-on top mounted dry shelving display	

## ADDITIONAL INFORMATION:

- Designed to maintain the critical temperature of the products within the display at a range of 38-41°F (3-5°C) with an ambient atmosphere of 75°F (24°C)/55% humidity. Designed for holding pre-chilled product only
- Hot gas condensate evaporation system (most units)
- ETL listed and Sanitation certified to NSF-7
- 1 year parts and labor warranty

# SINGLE-LEVEL SELF-SERVICE DISPLAY - 42"H

## STANDARD FEATURES SHOWN

## CUSTOM FEATURES SHOWN

FGD-24-42



FINISHES:  
STAIN,  
DANISH WALNUT



FINISHES:  
STAIN,  
OILED CHERRY

FGD-38-42



FINISHES:  
STAIN,  
DANISH WALNUT



FINISHES:  
STAIN,  
WEATHERED WOOD

FGD-48-42



FINISHES:  
STAIN,  
DANISH WALNUT



FINISHES:  
STAIN,  
SELECT CHERRY



# SINGLE-LEVEL SELF-SERVICE DISPLAY - 42"H

## STANDARD FEATURES SHOWN

FGD-57-42



FINISHES:  
STAIN,  
DANISH WALNUT

## CUSTOM FEATURES SHOWN



FINISHES:  
STAIN,  
DANISH WALNUT

FGD-76-42



FINISHES:  
STAIN,  
DANISH WALNUT



FINISHES:  
STAIN,  
OILED CHERRY

FGD-96-42



FINISHES:  
STAIN,  
DANISH WALNUT



FINISHES:  
STAIN,  
WEATHERED WOOD

# TWO-LEVEL SELF-SERVICE DISPLAY - 49"H

 REFRIGERATED

*Solid end panels shown*



*End panels with glass shown*

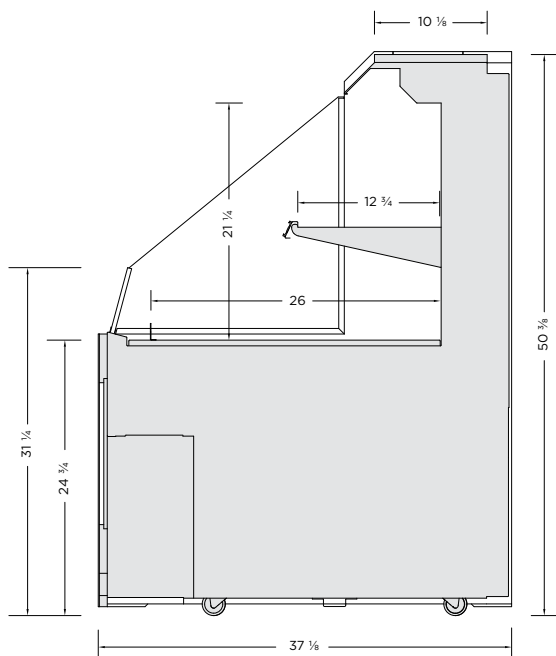

MODEL	LENGTH
FGD-24-49	26 1/4"
FGD-38-49	40 1/4"
FGD-48-49	49 7/8"
FGD-57-49	59 3/8"
FGD-76-49	78 1/2"
FGD-96-49	97 5/8"

## FEATURES:

- Brushed Stainless steel internal cabinet construction
- Many exterior natural wood finishes available
- 3 interior finish options: textured powdercoat black, white and brushed stainless steel
- Other custom options are offered. Refer to the options schedule on the next page
- A LED light strip is mounted on the top ledge of the display area. Various light intensities/ spectrums are available
- 1-12" adjustable metal shelf with integrated front product stop and LED light strip mounted to the bottom of the shelf
- Designed to maintain the critical temperature of the products within the display at a range of 38- 41°F (3-5°C) with an ambient atmosphere of 75°F (24°C)/55% humidity
- ETL electrical certification and NSF-7 standards
- New R-513A (non-ozone depleting, low global warming potential) refrigerant used in the self-contained refrigeration system
- The refrigeration system is designed to pull fresh air from the front base of the display and vent through an integrated rear vent. The unique rear vent allows the display to be backed up against a wall or other displays/obstructions
- Remote refrigeration available. Contact Cayuga Displays for details

## SUGGESTED APPLICATIONS:

 Cafe

 Restaurant

 Bakery

 Butcher Shop

 Deli

 Produce

Note: Information and specifications may change due to engineering improvements.





# TWO-LEVEL SELF-SERVICE DISPLAY - 49"H

 REFRIGERATED

TECHNICAL SPECS				
MODEL	LENGTH	VOLTS	AMPS	NEMA
FGD-24-49	26 ¼"	115	11.8	5-15P
FGD-38-49	40 ¼"	115	11.9	5-15P
FGD-48-49	49 ⅞"	115	12.0	5-15P
FGD-57-49	59 ⅜"	115/230	9.3	L14-20P
FGD-76-49	78 ½"	115/230	12.1	L14-20P
FGD-96-49	97 ⅝"	115/230	12.5	L14-20P

## STANDARD FEATURES:

- 3 interior finishes options: textured powdercoat black, white and brushed stainless steel
- Standard natural wood exterior panels
- Solid end panels with black or white interior finish
- A LED light strip is mounted on the top ledge of the display area
- 1-12" adjustable metal shelf with integrated front product stop and LED light strip mounted to the bottom of the shelf
- The refrigeration system is designed to pull fresh air from the front base of the display and vent through an integrated rear vent. The unique rear vent allows the display to be backed up against a wall or other displays/obstructions

## CUSTOM OPTIONS:

EXTERIOR FINISHES	
Oak Veneer Plywood	
- Vertical grain direction	
Birch/Maple Veneer Plywood	
- Vertical grain direction	
Clear Finish applied to veneer	
Stain Finish Choice _____	
1" black McCue impact bumper strip applied to the front of the display	
Other McCue impact bumper strip colors Available upon request	

## END PANELS

Interior laminate the same as exterior	
Brushed Stainless Steel interior	
Mirrored interior	
Tempered glass end panels	
Mirrored glass panels	
1" black McCue impact bumper strip applied to the front of the display	
Other McCue impact bumper strip colors Available upon request	

## MISCELLANEOUS OPTIONS

2 ½" H x 14"D Stepped Riser	
Perforated inlay panel for canted display	
Price tag moulding attached to shelf	
Roll-down thermal night curtain	
Heavy duty lockable casters	

## ADDITIONAL INFORMATION:

- Designed to maintain the critical temperature of the products within the display at a range of 38-41°F (3-5°C) with an ambient atmosphere of 75°F (24°C)/55% humidity. Designed for holding pre-chilled product only
- Hot gas condensate evaporation system (most units)
- ETL listed and Sanitation certified to NSF-7
- 1 year parts and labor warranty

# TWO-LEVEL SELF-SERVICE DISPLAY - 49"H

## STANDARD FEATURES SHOWN

## CUSTOM FEATURES SHOWN

FGD-24-49



FINISHES:  
STAIN,  
DANISH WALNUT



FINISHES:  
STAIN,  
OILED CHERRY

FGD-38-49



FINISHES:  
STAIN,  
DANISH WALNUT



FINISHES:  
STAIN,  
WEATHERED WOOD

FGD-48-49



FINISHES:  
STAIN,  
DANISH WALNUT



FINISHES:  
STAIN,  
SELECT CHERRY

# TWO-LEVEL SELF-SERVICE DISPLAY - 49"H

## STANDARD FEATURES SHOWN

## CUSTOM FEATURES SHOWN

FGD-57-49



FINISHES:  
STAIN,  
DANISH WALNUT



FINISHES:  
STAIN,  
DANISH WALNUT

FGD-76-49



FINISHES:  
STAIN,  
DANISH WALNUT



FINISHES:  
STAIN,  
OILED CHERRY

FGD-96-49



FINISHES:  
STAIN,  
DANISH WALNUT



FINISHES:  
STAIN,  
WEATHERED WOOD



# THREE-LEVEL SELF-SERVICE DISPLAY - 54"H

 REFRIGERATED

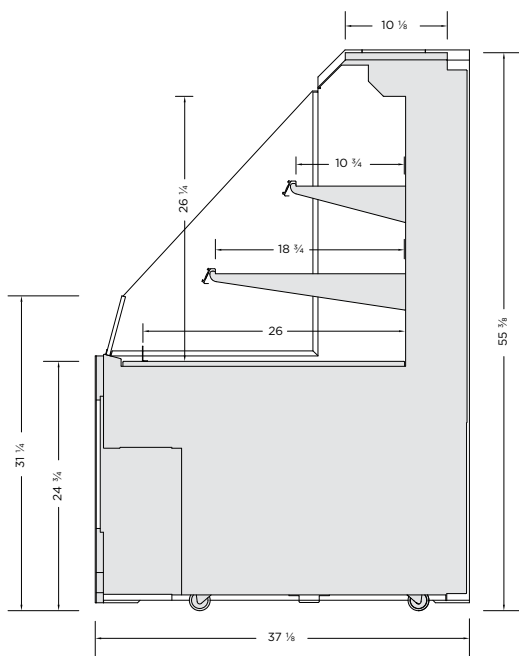

MODEL	LENGTH
FGD-24-54	26 1/4"
FGD-38-54	40 1/4"
FGD-48-54	49 7/8"
FGD-57-54	59 3/8"
FGD-76-54	78 1/2"
FGD-96-54	97 5/8"

## FEATURES:

- Brushed Stainless steel internal cabinet construction
- Many exterior natural wood finishes available
- 3 interior finish options: textured powdercoat black, white and brushed stainless steel
- Other custom options are offered. Refer to the options schedule on the next page
- A LED light strip is mounted on the top ledge of the display area. Various light intensities/spectrums are available
- 1-12" & 1-18" adjustable metal shelves with integrated front product stop and LED light strip mounted to the bottom of the shelves
- Designed to maintain the critical temperature of the products within the display at a range of 38-41°F (3-5°C) with an ambient atmosphere of 75°F (24°C)/55% humidity
- ETL electrical certification and NSF-7 standards
- New R-513A (non-ozone depleting, low global warming potential) refrigerant used in the self-contained refrigeration system
- The refrigeration system is designed to pull fresh air from the front base of the display and vent through an integrated rear vent. The unique rear vent allows the display to be backed up against a wall or other displays/obstructions
- Remote refrigeration available. Contact Cayuga Displays for details

## SUGGESTED APPLICATIONS:

 Cafe

 Restaurant

 Bakery

 Butcher Shop

 Deli

 Produce

Note: Information and specifications may change due to engineering improvements.



# THREE-LEVEL SELF-SERVICE DISPLAY - 54"H

REFRIGERATED

TECHNICAL SPECS				
MODEL	LENGTH	VOLTS	AMPS	NEMA
FGD-24-54	26 ¼"	115	11.8	5-15P
FGD-38-54	40 ¼"	115	11.9	5-15P
FGD-48-54	49 ⅞"	115	12.0	5-15P
FGD-57-54	59 ⅜"	115/230	9.8	L14-20P
FGD-76-54	78 ½"	115/230	12.6	L14-20P
FGD-96-54	97 ⅝"	115/230	13.0	L14-20P

## STANDARD FEATURES:

- 3 interior finishes options: textured powdercoat black, white and brushed stainless steel
- Standard natural wood exterior panels
- Solid end panels with black or white interior finish
- A LED light strip is mounted on the top ledge of the display area
- 1-12" & 1-18" adjustable metal shelves with integrated front product stop and LED light strip mounted to the bottom of the shelves
- The refrigeration system is designed to pull fresh air from the front base of the display and vent through an integrated rear vent. The unique rear vent allows the display to be backed up against a wall or other displays/obstructions

## CUSTOM OPTIONS:

EXTERIOR FINISHES	
Oak Veneer Plywood	
- Vertical grain direction	
Birch/Maple Veneer Plywood	
- Vertical grain direction	
Clear Finish applied to veneer	
Stain Finish Choice _____	
1" black McCue impact bumper strip applied to the front of the display	
Other McCue impact bumper strip colors Available upon request	

## END PANELS

Interior laminate the same as exterior	
Brushed Stainless Steel interior	
Mirrored interior	
Tempered glass end panels	
Mirrored glass panels	
1" black McCue impact bumper strip applied to the front of the display	
Other McCue impact bumper strip colors Available upon request	

## MISCELLANEOUS OPTIONS

2 ½" H x 14"D Stepped Riser	
Perforated inlay panel for canted display	
Price tag moulding attached to shelf	
Roll-down thermal night curtain	
Heavy duty lockable casters	

## ADDITIONAL INFORMATION:

- Designed to maintain the critical temperature of the products within the display at a range of 38-41°F (3-5°C) with an ambient atmosphere of 75°F (24°C)/55% humidity. Designed for holding pre-chilled product only
- Hot gas condensate evaporation system (most units)
- ETL listed and Sanitation certified to NSF-7
- 1 year parts and labor warranty

# THREE-LEVEL SELF-SERVICE DISPLAY - 54"H

## STANDARD FEATURES SHOWN

## CUSTOM FEATURES SHOWN

FGD-24-54



FINISHES:  
STAIN,  
DANISH WALNUT



FINISHES:  
STAIN,  
OILED CHERRY

FGD-38-54



FINISHES:  
STAIN,  
DANISH WALNUT



FINISHES:  
STAIN,  
WEATHERED WOOD

FGD-48-54



FINISHES:  
STAIN,  
DANISH WALNUT



FINISHES:  
STAIN,  
SELECT CHERRY



# THREE-LEVEL SELF-SERVICE DISPLAY - 54"H

## STANDARD FEATURES SHOWN

## CUSTOM FEATURES SHOWN

FGD-57-54



FINISHES:  
STAIN,  
DANISH WALNUT



FINISHES:  
STAIN,  
DANISH WALNUT

FGD-76-54



FINISHES:  
STAIN,  
DANISH WALNUT



FINISHES:  
STAIN,  
OILED CHERRY

FGD-96-54



FINISHES:  
STAIN,  
DANISH WALNUT



FINISHES:  
STAIN,  
WEATHERED WOOD

# MARKET BIN



8' 11 ¼"L Market Bin w/ Base Merchandising shown  
(refer to pages 21 & 22)

*Finish: Weathered Wood*



5' 11 ½"L Market Bin shown  
(refer to pages 18 & 22)

*Finish: Natural Maple*



8' 11 ¼"L Market Bin shown  
(refer to pages 19, 22 & 23)

## Applications

- The market bin collection can be stand-alone, line-up or island configurations

# MARKET BIN



MODEL	DESCRIPTION	LENGTH	DEPTH	HEIGHT
TBOR-060-01B	Market Bin	35 ¾"	35 ¾"	31 ¼"
TBOR-061-01B	Market Bin - Tall	35 ¾"	35 ¾"	35 ¼"

## FEATURES:

- Birch/maple plywood and MDF construction
- Nylon tack glides
- Corner guards

## OPTIONS:

- ABS haircell liner
- ABS tray (no drain)
- Wire cage
- Heavy duty casters (2 locking)
- 1 ½" ABS bumper
- Refer to Wood Stains Finishes

Note: Information and specifications may change due to engineering improvements.

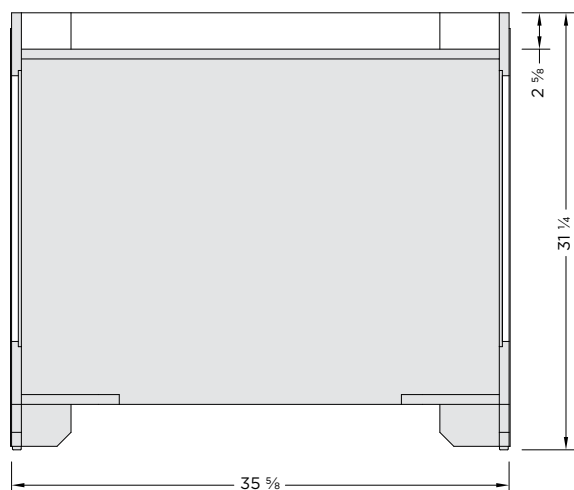

TBOR-060-01B

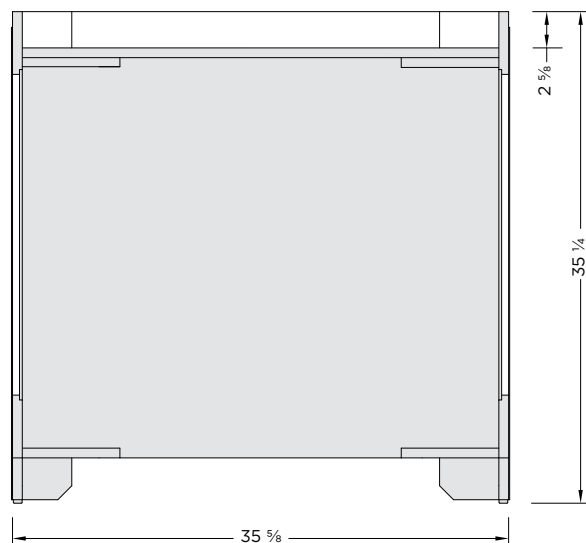

TBOR-061-01B



# MARKET BIN WITH BASE MERCHANDISING



MODEL	DESCRIPTION	LENGTH	DEPTH	HEIGHT
TBOR-062-01B	Market Bin	35 ¾"	35 ¾"	31 ¼"
TBOR-063-01B	Market Bin - Tall	35 ¾"	35 ¾"	35 ¼"

## FEATURES:

- Birch/maple plywood, solid maple, melamine and MDF construction
- Nylon tack glides
- Corner guards

## OPTIONS:

- ABS haircell liner
- ABS tray (no drain)
- Wire cage
- Heavy duty casters (2 locking)
- 1 ½" ABS bumper
- Refer to Wood Stains Finishes

Note: Information and specifications may change due to engineering improvements.

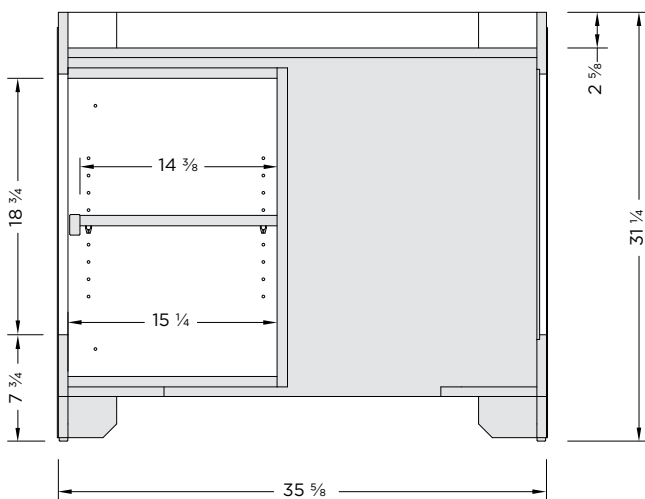

TBOR-062-01B

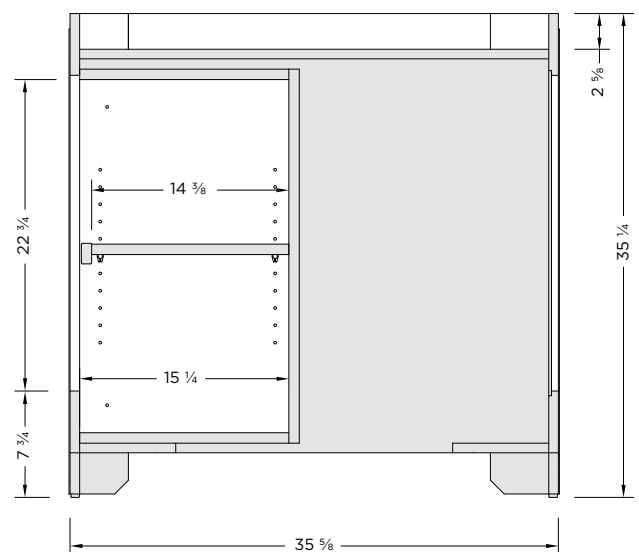

TBOR-063-01B

# MARKET ICE BIN



Clear finish shown



Iron Mountain finish shown. Other finishes available - see chart.

MODEL	DESCRIPTION	LENGTH	DEPTH	HEIGHT
TBOR-064-01B	Market Ice Bin with ABS Tray	35 3/4"	35 3/4"	31 3/8"
TBOR-065-01B	Market Ice Bin with ABS Tray - Tall	35 3/4"	35 3/4"	35 3/8"

## FEATURES:

- Birch/maple plywood and MDF construction
- Nylon tack glides
- Corner guards
- ABS tray with insulation, drain, valve, hose, 5 gallon bucket & access door

## OPTIONS:

- 1 1/2" ABS bumper
- Heavy duty casters (2 locking)
- Refer to Wood Stains Finishes

Note: Information and specifications may change due to engineering improvements.

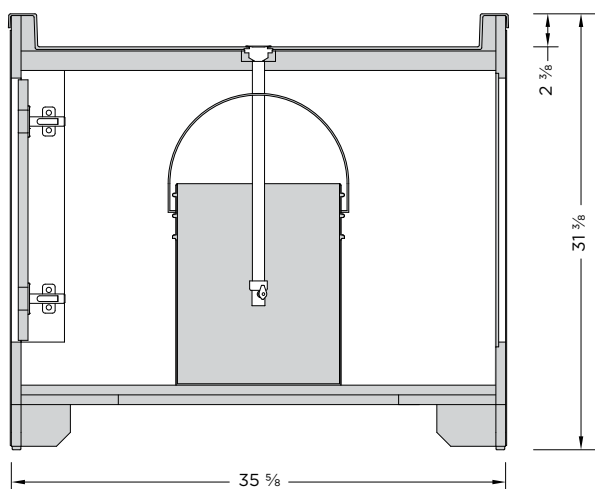

TBOR-064-01B

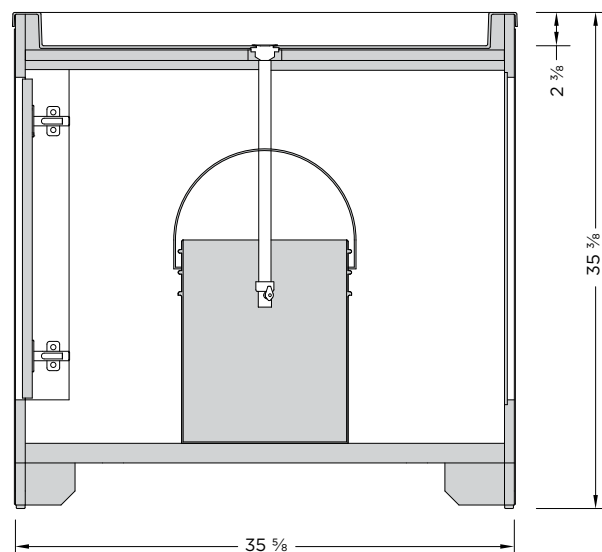

TBOR-065-01B

# MARKET ICE BIN WITH BASE MERCHANDISING



Clear finish shown



Choco Cherry finish  
shown. Other finishes  
available - see chart.

MODEL	DESCRIPTION	LENGTH	DEPTH	HEIGHT
TBOR-066-01B	Market Ice Bin with ABS Tray	35 3/4"	35 3/4"	31 3/8"
TBOR-067-01B	Market Ice Bin with ABS Tray - Tall	35 3/4"	35 3/4"	35 3/8"

## FEATURES:

- Birch/maple plywood, solid maple, melamine and MDF construction
- Nylon tack glides
- Corner guards
- ABS tray with insulation, drain, valve, hose, 5 gallon bucket & access door

## OPTIONS:

- 1 1/2" ABS bumper
- Heavy duty casters (2 locking)
- Refer to Wood Stains Finishes

Note: Information and specifications may change due to engineering improvements.

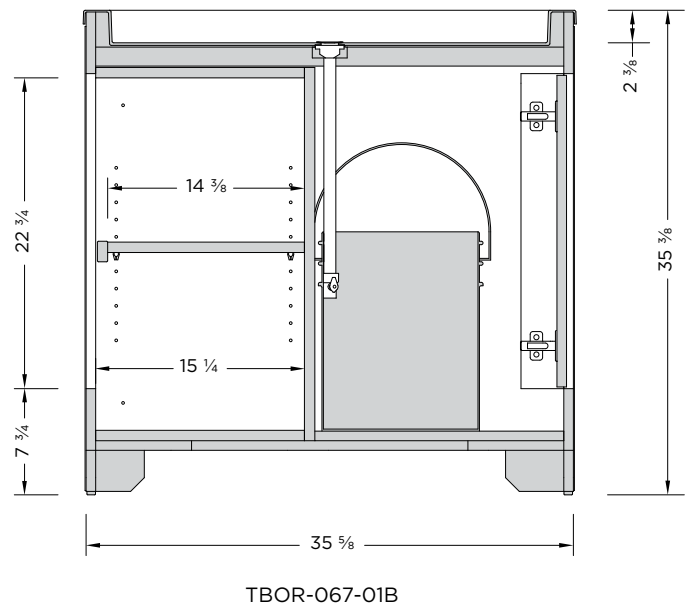
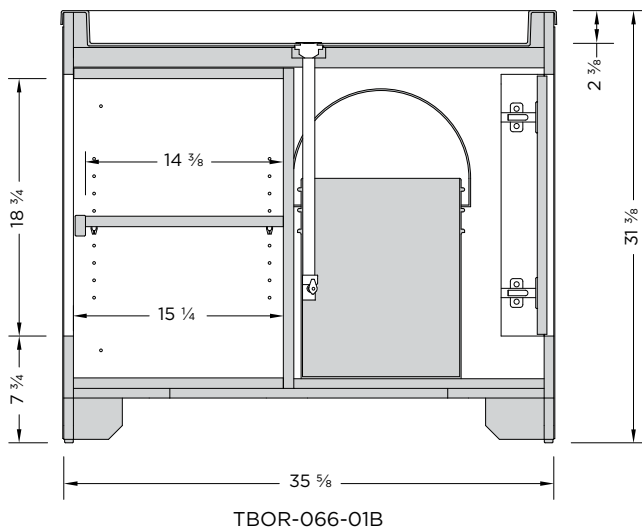



# WING TABLES - 3 OPEN SIDES



Clear finish shown



Weathered Wood finish w/optional ABS Tray shown. Other finishes available - see chart.

MODEL	DESCRIPTION	LENGTH	DEPTH	HEIGHT
TBOR-078-01B	Wing Table - 3 Open Sides	34 $\frac{7}{8}$ "	17 $\frac{7}{8}$ "	31 $\frac{1}{4}$ "
TBOR-078-01C	Wing Table - 3 Open Sides w/ ABS Tray	35 $\frac{3}{8}$ "	18 $\frac{3}{8}$ "	31 $\frac{3}{8}$ "

## FEATURES:

- Birch/maple plywood and solid maple construction
- Adjustable shelf on shelf pins
- Nylon tack glides
- Protective corner guards
- TBOR-078-01C
  - ABS tray without drain

## OPTIONS:

- ABS haircell liner
- $\frac{1}{2}$ " Foam insert
- 1  $\frac{1}{2}$ " ABS bumper
- Refer to Wood Stains Finishes

Note: Information and specifications may change due to engineering improvements.

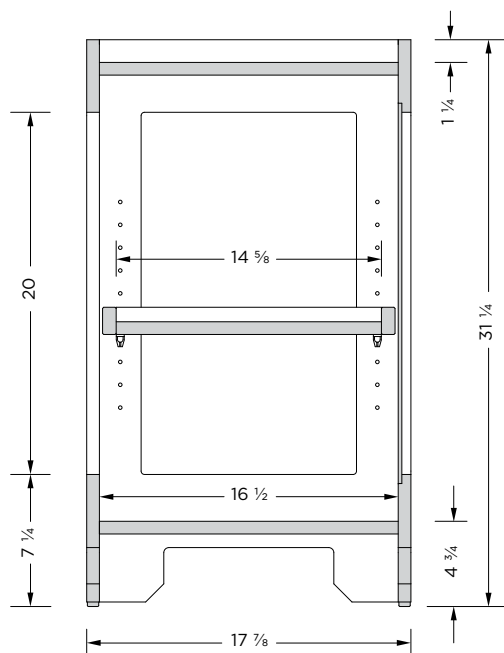

TBOR-078-01B

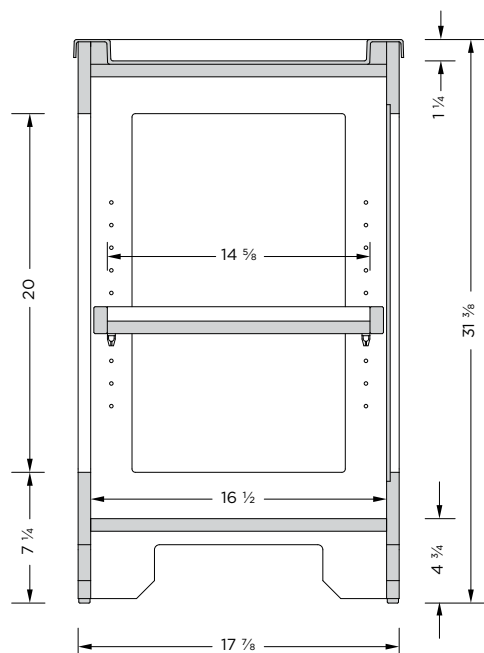

TBOR-078-01C

# CLOSED WING TABLES

Clear finish shown



Concerto finish w/  
optional ABS Tray  
shown. Other finishes  
available - see chart.

MODEL	DESCRIPTION	LENGTH	DEPTH	HEIGHT
TBOR-079-01B	Closed Wing Table	34 7/8"	17 7/8"	31 1/4"
TBOR-079-01C	Closed Wing Table w/ ABS Tray	35 3/8"	18 3/8"	31 3/8"

## FEATURES:

- Birch/maple plywood and solid maple construction
- Adjustable shelf on shelf pins
- Nylon tack glides
- Protective corner guards
- TBOR-079-01C
  - ABS tray without drain

## OPTIONS:

- ABS haircell liner
- 1/2" Foam insert
- 1 1/2" ABS bumper
- Refer to Wood Stains Finishes

Note: Information and specifications may change due to engineering improvements.

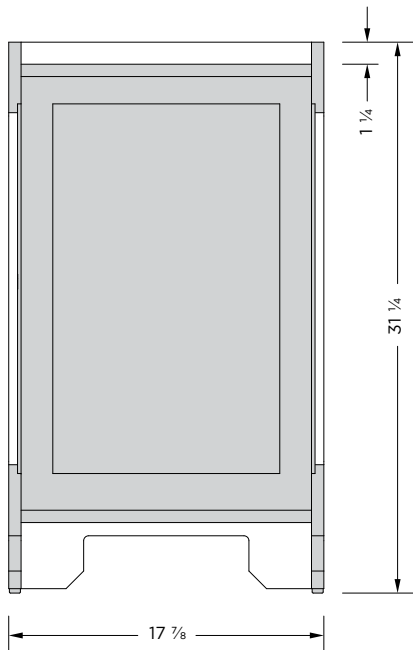

TBOR-079-01B

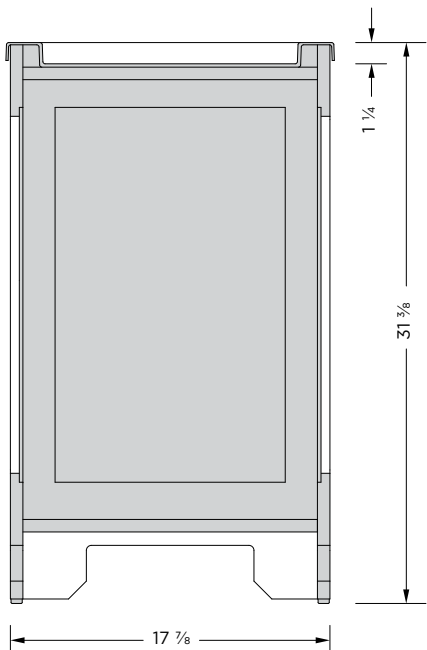

TBOR-079-01C





# CRITICAL TEMPERATURE SINGLE POD MOBILE MERCHANDISER

 REFRIGERATED

3' X 3' & 4' X 4' SINGLE POD SIZES, CREATE A UNIQUE REFRIGERATED MOBILE DISPLAY



*Shown with  
natural wood  
panels*



*Shown with black  
laminate panels*

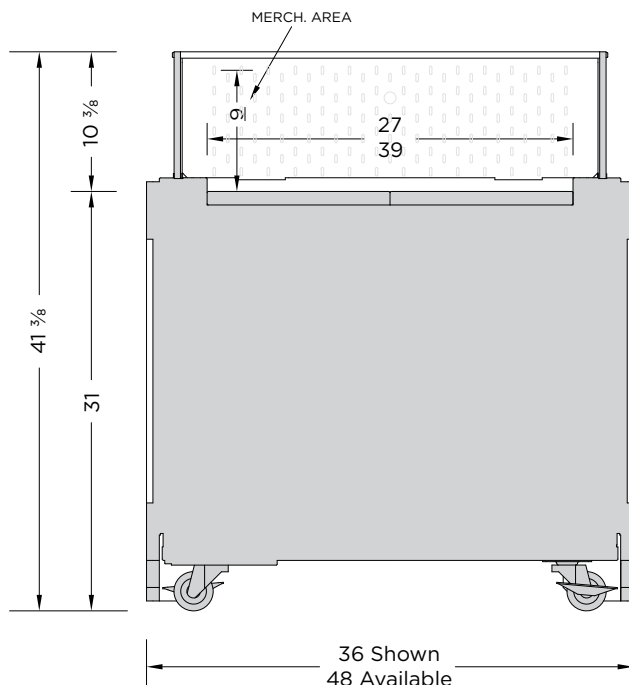

MODEL	DÉCOR PANELS	LENGTH	WIDTH
FGB3-0132-S	D,E	36"	36"
FGB4-0132-S	D,E	48"	48"

## FEATURES:

- Display fresh juices, cut fruits, yogurts, deli meats, cheeses, bakery etc.
- Designed to maintain critical product temperature at 38-41°F with a unique 9" high merchandising area
- A mobile display with self-contained refrigeration that plugs into a 115V dedicated circuit and R-513A refrigerant (non-ozone depleting, low-global warming potential)
- A unique attachment system designed to provide the flexibility to incorporate a collection of standard exterior décor panels (Panel E option shown) or customized panels can be created to match your decor or brand image
- The standard décor panels are constructed of natural wood veneers with a variety of stain colours available
- A wide range of laminates, metals and wood finishes to choose from for a customized look
- Protective corners are applied to prevent damage to the décor panels
- Removable black "Ultra-Durable Texture™" powder coated flat base inlays
- Heavy duty casters
- Fresh Go Bins™ are also available in 2 pod configurations. Specification sheet available

## SUGGESTED APPLICATIONS:



Bakery



Produce



Deli

Note: Information and specifications may change due to engineering improvements.



FRESH GO BIN™

# CRITICAL TEMPERATURE SINGLE POD MOBILE MERCHANDISER

REFRIGERATED

## ELECTRICAL SPECS (SELF-CONTAINED)

MODEL	VOLTS	AMPS	PLUG
FGB3-0132-S	115	10	5-15P
FGB4-0132-S	115	12	5-20P

## INTERIOR FINISH

Brushed Stainless Steel	
Textured Black	
Textured White	

## EXTERIOR FINISHES

Black	
White	
Brushed Stainless Steel	
Painted Metal Standard _____	
Custom _____	
Formica laminate finish: ____	
Other laminate finish (specify): ____	
Oak Veneer Plywood	
- Vertical grain direction	
Birch/Maple Veneer Plywood	
- Vertical grain direction	
Clear Finish applied to Veneer	
Stain Finish Choice _____	
1" black McCue impact bumper strip applied to the front of the display	
Other McCue impact bumper strip colors Available upon request	

## STANDARD DÉCOR PANELS

Panel D	
Panel E	
Custom panel option	

## AVAILABLE DÉCOR PANEL OPTIONS

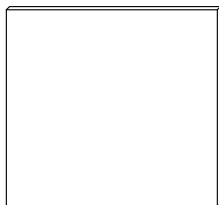

Panel D

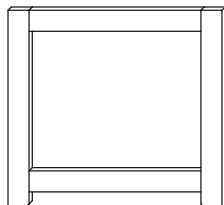

Panel E

## MISCELLANEOUS OPTIONS

Dry merchandising shelf & sign pole (optional LED lighting)	
Sign pole	
Serrated Inlays	

## ADDITIONAL FEATURES:

- Designed to maintain product temperature of 38-41°F with a maximum ambient atmosphere of 75°F/55% humidity
- Hot gas condensate evaporation system
- ETL Listed and Sanitation certified to NSF 7
- 1 Year Parts & Labour Warranty

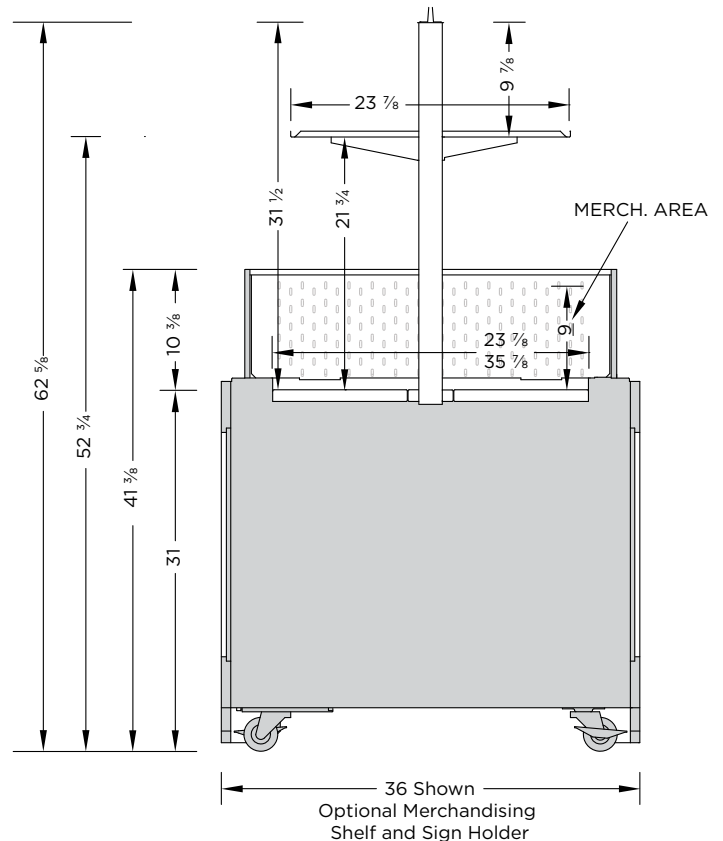

# CRITICAL TEMPERATURE 2-POD MERCHANDISER

 REFRIGERATED

3' X 6' 2-POD SIZE, CREATE A UNIQUE REFRIGERATED MOBILE OR STATIONARY DISPLAY



MODEL	DÉCOR PANELS	LENGTH	WIDTH
FGB3-0232-S	D,E	72"	36"

## FEATURES:

- Display fresh juices, cut fruits, yogurts, deli meats, cheeses, bakery etc.
- Designed to maintain critical product temperature at 38-41°F with a unique 9" high merchandising area
- A mobile display with self-contained refrigeration that plugs into a 115V dedicated circuit and R-513A refrigerant (non-ozone depleting, low-global warming potential)
- A unique attachment system designed to provide the flexibility to incorporate a collection of standard exterior décor panels (Panel E option shown) or customized panels can be created to match your decor or brand image
- The standard décor panels are constructed of natural wood veneers with a variety of stain colours available
- A wide range of laminates, metals and wood finishes to choose from for a customized look
- Protective corners are applied to prevent damage to the décor panels
- Removable black "Ultra-Durable Texture™" powder coated flat base inlays
- Heavy duty casters
- Fresh Go Bins™ are also available in single pod configurations. Specification sheet available

## SUGGESTED APPLICATIONS:

 Bakery

 Produce

 Deli

Note: Information and specifications may change due to engineering improvements.

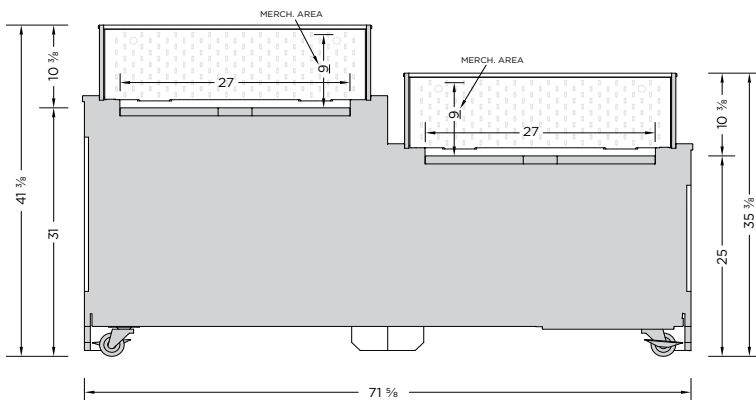





FRESH GO BIN™

# CRITICAL TEMPERATURE 2-POD MERCHANDISER

REFRIGERATED

## ELECTRICAL SPECS (SELF-CONTAINED)

MODEL	VOLTS	AMPS	PLUG
FGB3-0232-S	115	13.8	5-20P

## INTERIOR FINISH

Brushed Stainless Steel	
Textured Black	
Textured White	

## EXTERIOR FINISHES

Black	
White	
Brushed Stainless Steel	
Painted Metal Standard _____	
Custom _____	
Formica laminate finish: _____	
Other laminate finish (specify): _____	
Oak Veneer Plywood	
- Vertical grain direction	
Birch/Maple Veneer Plywood	
- Vertical grain direction	
Clear Finish applied to Veneer	
Stain Finish Choice _____	
1" black McCue impact bumper strip applied to the front of the display	
Other McCue impact bumper strip colors Available upon request	

## STANDARD DÉCOR PANELS

Panel D	
Panel E	
Custom panel option	

## AVAILABLE DÉCOR PANEL OPTIONS



Panel D

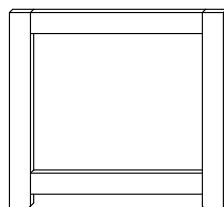

Panel E

## MISCELLANEOUS OPTIONS

Dry merchandising shelf & sign pole (optional LED lighting)	
Sign pole	
Serrated Inlays	

## ADDITIONAL FEATURES:

- Designed to maintain product temperature of 38-41°F with a maximum ambient atmosphere of 75°F/55% humidity
- Hot gas condensate evaporation system
- 1 Year Parts & Labour Warranty

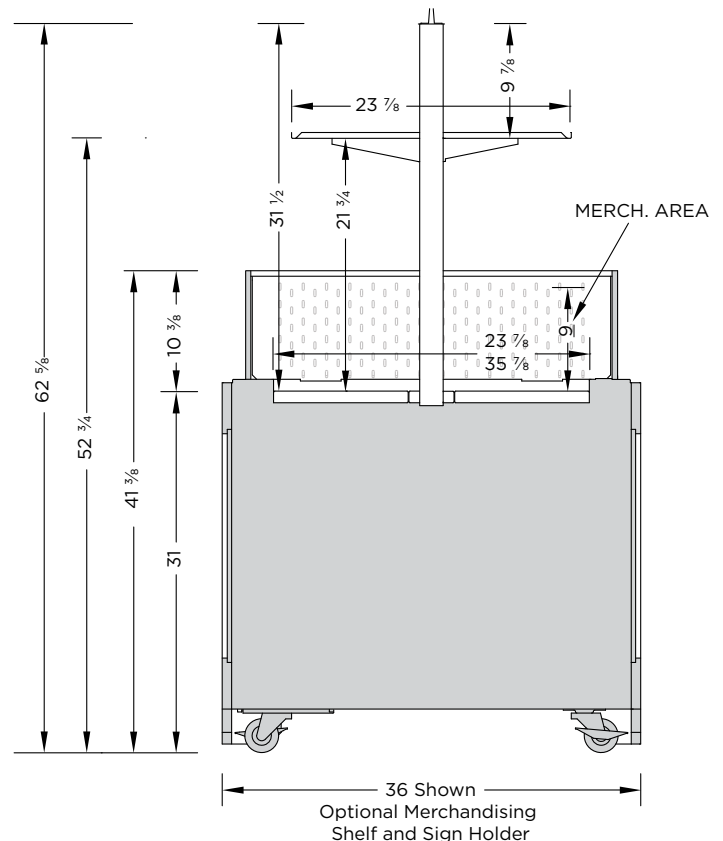

# FRESHGO BIN ACCESSORIES

## DRY MERCHANDISING SHELF & SIGN POLE

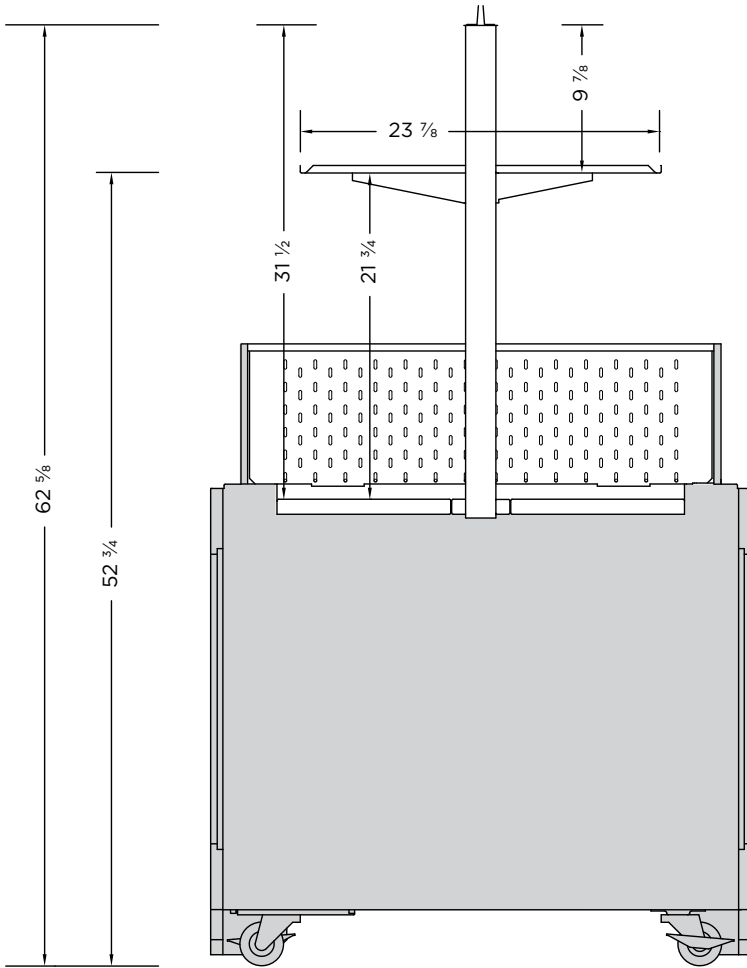

PART #	DESCRIPTION
FGB-022-01	24" x 24" x 31 1/2" Dry Merchandising Shelf & Sign Pole
FGB-022-02	24" x 24" x 31 1/2" Dry Merchandising Shelf & Sign Pole and LED Lighting

# FRESHGO BIN ACCESSORIES

## SIGN POLE

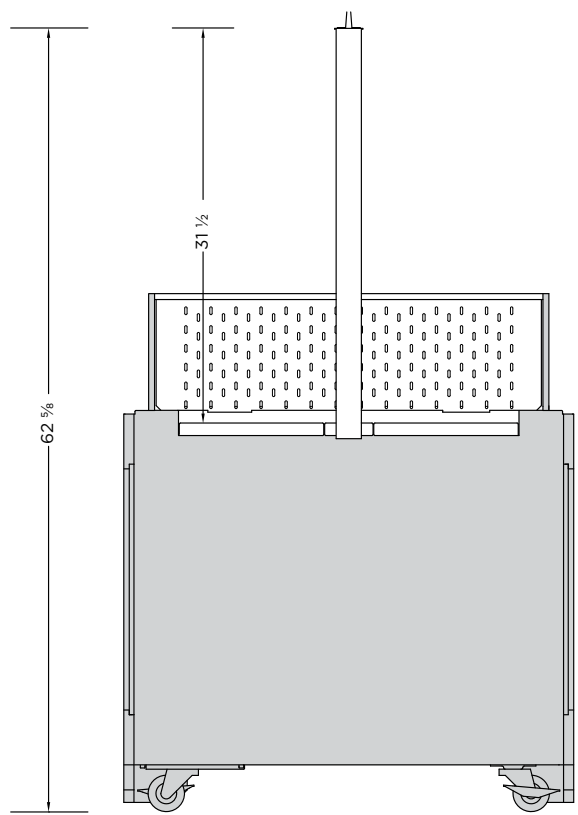

PART #	DESCRIPTION
FGB-022-03	Sign Pole

## SERRATED INLAY

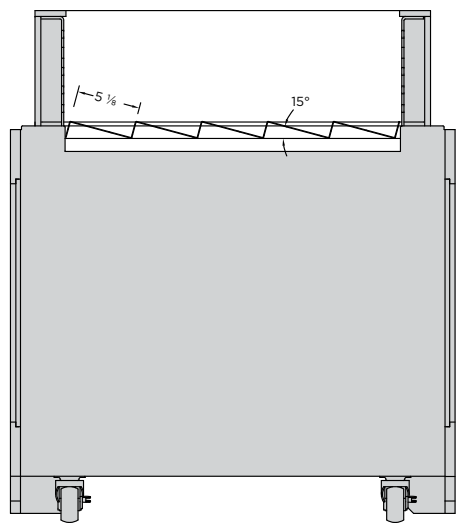

PART #	DESCRIPTION
FGB-022-04	Serrated Inlay (2 Required)



# THREE-LEVEL UPRIGHT SELF-SERVICE DISPLAY – 53”H

 REFRIGERATED



*Standard features shown*



*Custom options available, refer to options schedule on next page.*

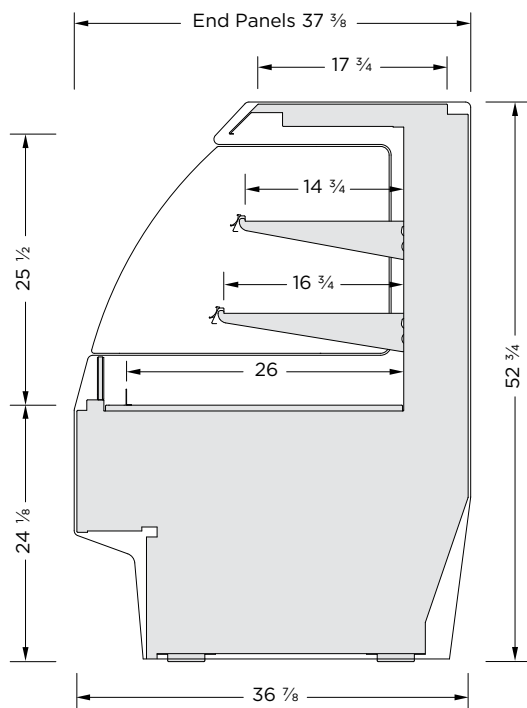

MODEL	LENGTH
MD3M-24-53	26"
MD3M-38-53	40 $\frac{1}{4}$ "
MD3M-48-53	49 $\frac{7}{8}$ "
MD3M-57-53	59 $\frac{3}{8}$ "
MD3M-76-53	78 $\frac{1}{2}$ "
MD3M-96-53	97 $\frac{5}{8}$ "

## FEATURES:

- Many exterior finish options available: powdercoat paint, brushed stainless steel, laminates and natural wood finishes
- 3 interior finish options: textured powdercoat black, white and brushed stainless steel
- Other custom options are offered. Refer to the options schedule on the next page
- A LED light strip is mounted on the top ledge of the display area.
- 1-14" and 1-16" adjustable metal shelves with integrated LED lighting.
- The LED lighting is available in various light intensities/spectrums
- Designed to maintain the critical temperature of the products within the display at a range of 38-41°F (3-5°C) with an ambient atmosphere of 75°F (24°C)/55% humidity
- ETL electrical certification and NSF 7 standards
- New R-513A (non-ozone depleting, low global warming potential) refrigerant used in the self-contained refrigeration system
- The refrigeration system is designed to pull fresh air from the front base of the display and vent through an integrated rear vent. The unique rear vent allows the display to be backed up against a wall or other displays/obstructions
- Remote refrigeration available. Contact Cayuga Displays for details

## SUGGESTED APPLICATIONS:



Note: Information and specifications may change due to engineering improvements.



# THREE-LEVEL UPRIGHT SELF-SERVICE DISPLAY - 53"H

REFRIGERATED

## TECHNICAL SPECS

MODEL	LENGTH	VOLTS	AMPS	NEMA PLUG
MD3M-24-53	26"	115	11.7	5-15P
MD3M-38-53	40 ¼"	115	11.7	5-15P
MD3M-48-53	49 ⅞"	115	11.7	5-15P
MD3M-57-53	59 ⅞"	115/230	8.7	L14-20P
MD3M-76-53	78 ½"	115/230	12.4	L14-20P
MD3M-96-53	97 ⅞"	115/230	12.4	L14-20P

## STANDARD FEATURES:

- 3 interior finish options: textured powdercoat black, white and brushed stainless steel
- Black or white laminate exterior finish
- Solid End Panels with black or white interior finish
- A LED light strip is mounted on the top ledge of the display area
- 1-14" and 1-16" adjustable metal shelves with integrated LED lighting
- The refrigeration system is designed to pull fresh air from the front base of the display and vent through an integrated rear vent. The unique rear vent allows the display to be backed up against a wall or other displays/obstructions

## CUSTOM FEATURES:

### EXTERIOR FINISHES

Formica laminate finish: _____	
Other laminate finish (specify): _____	
Customer laminate choices	
Brushed Stainless Steel	
Oak Veneer Plywood	
- Vertical grain direction	
- Horizontal grain direction	
Birch/Maple Veneer Plywood	
- Vertical grain direction	
- Horizontal grain direction	
Clear finish applied to veneer	
Stain finish Choice: _____	
1" black McCue impact bumper strip applied to the front of the display	
Other McCue impact bumper strip colors available upon request	

### END PANELS

Interior laminate the same as exterior	
Brushed Stainless Steel interior	
Mirrored interior	
Tempered glass end panels	
Mirrored glass panels	
1" black McCue impact bumper strip applied to the front of the display	
Other McCue impact bumper strip colors available upon request	

### MISCELLANEOUS

Additional shelf with integrated LED lighting	
Tempered glass shelves with integrated LED lighting	
Roll-down thermal night curtain	
Heavy duty lockable casters	

## ADDITIONAL FEATURES:

- Designed to maintain the critical temperature of the products within the display at a range of 38-41°F (3-5°C) with an ambient atmosphere of 75°F (24°C)/55% humidity. Designed for holding pre-chilled product only
- Hot gas condensate evaporation system (most units)
- ETL listed and Sanitation certified to NSF-7
- 1 year parts and labor warranty

# THREE-LEVEL UPRIGHT SELF-SERVICE DISPLAY – 53”H

## STANDARD FEATURES SHOWN

## CUSTOM FEATURES SHOWN

### MD3M-24-53



FINISHES:  
POWDERCOAT,  
TEXTURED BLACK



FINISHES:  
LAMINATE,  
BRAZILWOOD (7946)

### MD3M-38-53



FINISHES:  
POWDERCOAT,  
TEXTURED BLACK



FINISHES:  
LAMINATE,  
SOFT GOLD MESH (4911)

### MD3M-48-53



FINISHES:  
POWDERCOAT,  
TEXTURED BLACK

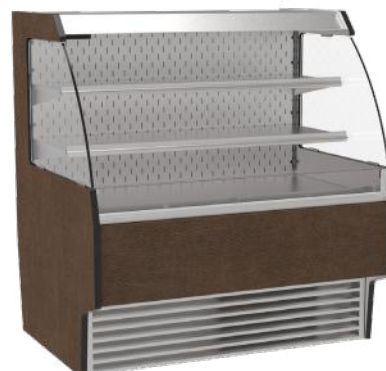

FINISHES:  
LAMINATE,  
WINDSWEPT BRONZE (4795)



# THREE-LEVEL UPRIGHT SELF-SERVICE DISPLAY - 53"H

## STANDARD FEATURES SHOWN

## CUSTOM FEATURES SHOWN

### MD3M-57-53



FINISHES:  
POWDERCOAT,  
TEXTURED BLACK



FINISHES:  
LAMINATE,  
VAPOR STRANDZ (4939K)

### MD3M-76-53



FINISHES:  
POWDERCOAT,  
TEXTURED BLACK



FINISHES:  
LAMINATE,  
SPROUT (4918)

### MD3M-96-53

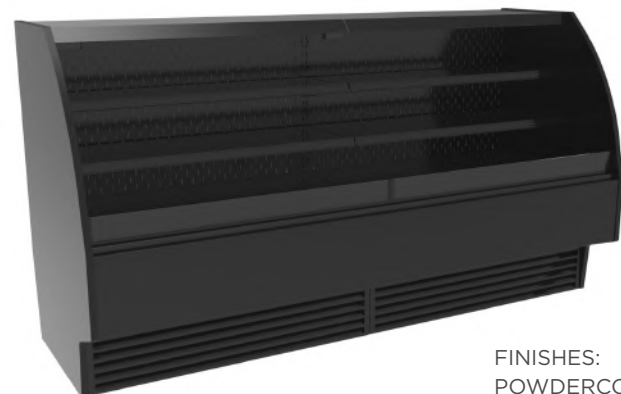

FINISHES:  
POWDERCOAT,  
TEXTURED BLACK



FINISHES:  
LAMINATE,  
OLD MILL OAK (7973K)

# FOUR-LEVEL UPRIGHT SELF-SERVICE DISPLAY – 63”H

 REFRIGERATED



*Custom options available, refer to options schedule on next page.*

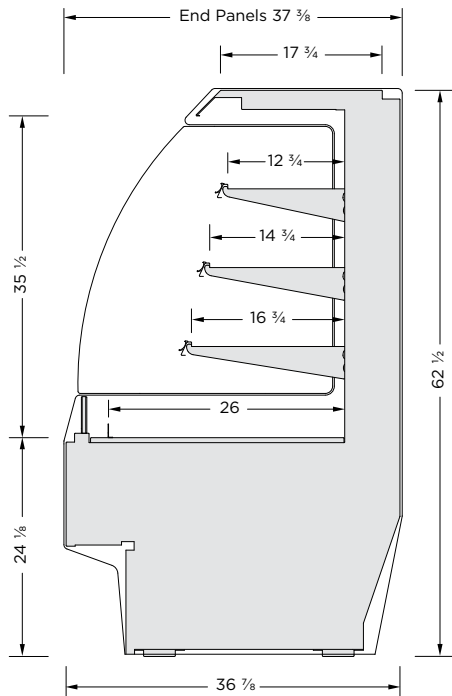

MODEL	LENGTH
MD4M-24-63	26"
MD4M-38-63	40 1/4"
MD4M-48-63	49 7/8"
MD4M-57-63	59 3/8"
MD4M-76-63	78 1/2"
MD4M-96-63	97 5/8"

## FEATURES:

- Many exterior finish options available: powdercoat paint, brushed stainless steel, laminates and natural wood finishes
- 3 interior finish options: textured powdercoat black, white and brushed stainless steel
- Other custom options are offered. Refer to the options schedule on the next page
- A LED light strip is mounted on the top ledge of the display area.
- 1-12", 1-14" and 1-16" adjustable metal shelves with integrated LED lighting.
- The LED lighting is available in various light intensities/spectrums
- Designed to maintain the critical temperature of the products within the display at a range of 38- 41°F (3-5°C) with an ambient atmosphere of 75°F (24°C)/55% humidity
- ETL electrical certification and NSF 7 standards
- New R-513A (non-ozone depleting, low global warming potential) refrigerant used in the self-contained refrigeration system
- The refrigeration system is designed to pull fresh air from the front base of the display and vent through an integrated rear vent. The unique rear vent allows the display to be backed up against a wall or other displays/obstructions
- Remote refrigeration available. Contact Cayuga Displays for details

## SUGGESTED APPLICATIONS:



Note: Information and specifications may change due to engineering improvements.



# FOUR-LEVEL UPRIGHT SELF-SERVICE DISPLAY - 63"H

REFRIGERATED

## TECHNICAL SPECS

MODEL	LENGTH	VOLTS	AMPS	NEMA PLUG
MD4M-24-63	26"	115	11.7	5-15P
MD4M-38-63	40 ¼"	115	11.7	5-15P
MD4M-48-63	49 ⅞"	115	11.7	5-15P
MD4M-57-63	59 ⅞"	115/230	8.7	L14-20P
MD4M-76-63	78 ½"	115/230	12.4	L14-20P
MD4M-96-63	97 ⅞"	115/230	12.4	L14-20P

## STANDARD FEATURES:

- 3 interior finish options: textured powdercoat black, white and brushed stainless steel
- Black or white laminate exterior finish
- Solid End Panels with black or white interior finish
- A LED light strip is mounted on the top ledge of the display area
- 1-12", 1-14" and 1-16" adjustable metal shelves with integrated LED lighting
- The refrigeration system is designed to pull fresh air from the front base of the display and vent through an integrated rear vent. The unique rear vent allows the display to be backed up against a wall or other displays/obstructions

## CUSTOM FEATURES:

### EXTERIOR FINISHES

Formica laminate finish: _____	
Other laminate finish (specify): _____	
Customer laminate choices	
Brushed Stainless Steel	
Oak Veneer Plywood	
- Vertical grain direction	
- Horizontal grain direction	
Birch/Maple Veneer Plywood	
- Vertical grain direction	
- Horizontal grain direction	
Clear finish applied to veneer	
Stain finish Choice: _____	
1" black McCue impact bumper strip applied to the front of the display	
Other McCue impact bumper strip colors available upon request	

### END PANELS

Interior laminate the same as exterior	
Brushed Stainless Steel interior	
Mirrored interior	
Tempered glass end panels	
Mirrored glass panels	
1" black McCue impact bumper strip applied to the front of the display	
Other McCue impact bumper strip colors available upon request	

### MISCELLANEOUS

Additional shelf with integrated LED lighting	
Tempered glass shelves with integrated LED lighting	
Roll-down thermal night curtain	
Heavy duty lockable casters	

## ADDITIONAL FEATURES:

- Designed to maintain the critical temperature of the products within the display at a range of 38-41°F (3-5°C) with an ambient atmosphere of 75° (24°C)/55% humidity. Designed for holding pre-chilled product only
- Hot gas condensate evaporation system (most units)
- ETL listed and sanitation certified to NSF 7
- 1 year parts and labor warranty

# FOUR-LEVEL UPRIGHT SELF-SERVICE DISPLAY – 63”H

## STANDARD FEATURES SHOWN

## CUSTOM FEATURES SHOWN

### MD4M-24-63



FINISHES:  
POWDERCOAT,  
TEXTURED BLACK



FINISHES:  
LAMINATE,  
BRAZILWOOD (7946)

### MD4M-38-63



FINISHES:  
POWDERCOAT,  
TEXTURED BLACK



FINISHES:  
LAMINATE,  
SOFT GOLD MESH (4911)

### MD4M-48-63



FINISHES:  
POWDERCOAT,  
TEXTURED BLACK



FINISHES:  
LAMINATE,  
WINDSWEPT BRONZE (4795)



# FOUR-LEVEL UPRIGHT SELF-SERVICE DISPLAY - 63”H

## STANDARD FEATURES SHOWN

## CUSTOM FEATURES SHOWN

MD4M-57-63



FINISHES:  
POWDERCOAT,  
TEXTURED BLACK



FINISHES:  
LAMINATE,  
VAPOR STRANDZ (4939K)

MD4M-76-63



FINISHES:  
POWDERCOAT,  
TEXTURED BLACK

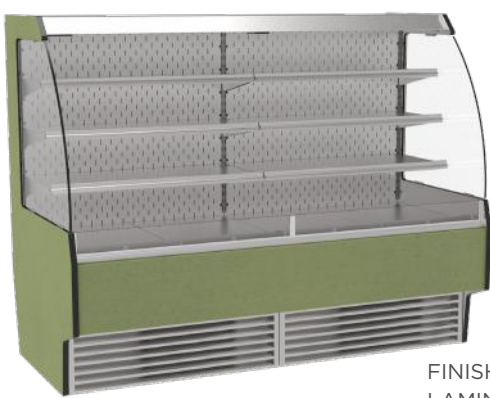

FINISHES:  
LAMINATE,  
SPROUT (4918)

MD4M-96-63

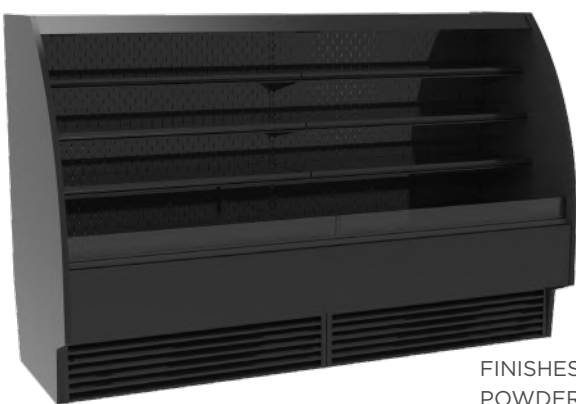

FINISHES:  
POWDERCOAT,  
TEXTURED BLACK



FINISHES:  
LAMINATE,  
OLD MILL OAK (7973K)

# SINGLE-LEVEL SELF-SERVICE DISPLAY - 42"H

 REFRIGERATED



Custom options available, refer to options schedule on next page.

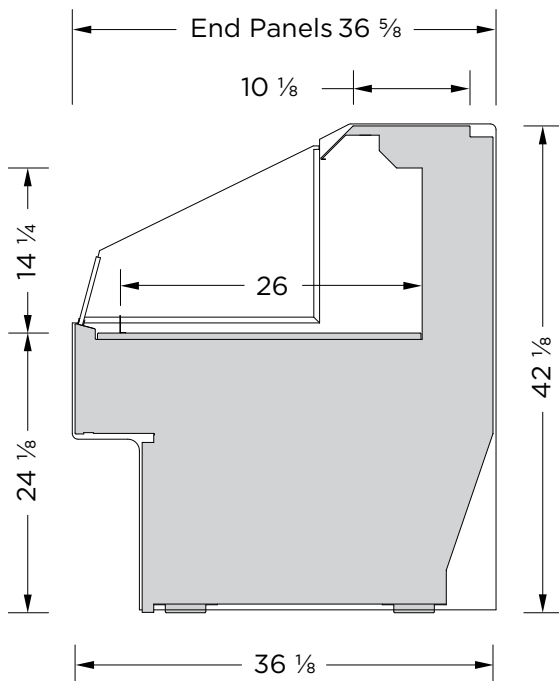

MODEL	LENGTH
MRO-24-42	26 1/4"
MRO-38-42	40 1/4"
MRO-48-42	49 7/8"
MRO-57-42	59 3/8"
MRO-76-42	78 1/2"
MRO-96-42	97 5/8"

## FEATURES:

- Brushed Stainless steel internal cabinet construction
- Many exterior finish options available: powdercoat paint, brushed stainless steel, laminates and natural wood finishes
- 3 interior finish options: textured powdercoat black, white and brushed stainless steel
- Other custom options are offered. Refer to the options schedule on the next page
- A LED light strip is mounted on the top ledge of the display area. Various light intensities/ spectrums are available
- Designed to maintain the critical temperature of the products within the display at a range of 38-41°F (3-5°C) with an ambient atmosphere of 75°F (24°C)/55% humidity
- ETL electrical certification and NSF-7 standards
- New R-513A (non-ozone depleting, low global warming potential) refrigerant used in the self-contained refrigeration system
- The refrigeration system is designed to pull fresh air from the front base of the display and vent through an integrated rear vent. The unique rear vent allows the display to be backed up against a wall or other displays/ obstructions
- Remote refrigeration available. Contact Cayuga Displays for details

## SUGGESTED APPLICATIONS:

 Cafe

 Restaurant

 Bakery

 Butcher Shop

 Deli

 Produce

Note: Information and specifications may change due to engineering improvements.



# SINGLE-LEVEL SELF-SERVICE DISPLAY - 42"H

REFRIGERATED

## TECHNICAL SPECS

MODEL	LENGTH	VOLTS	AMPS	NEMA PLUG
MRO-24-42	26 ¼"	115	11.8	5-15P
MRO-38-42	40 ¼"	115	11.9	5-15P
MRO-48-42	49 ⅞"	115	12.0	5-15P
MRO-57-42	59 ⅝"	115/230	9.3	L14-20P
MRO-76-42	78 ½"	115/230	12.1	L14-20P
MRO-96-42	97 ⅝"	115/230	12.5	L14-20P

## STANDARD FEATURES:

- 3 interior finishes options: textured powdercoat black, white and brushed stainless steel
- Black or white laminate exterior finish
- Solid end panels with black or white interior finish
- A LED light strip is mounted on the top ledge of the display area
- The refrigeration system is designed to pull fresh air from the front base of the display and vent through an integrated rear vent. The unique rear vent allows the display to be backed up against a wall or other displays/obstructions

## CUSTOM FEATURES:

### EXTERIOR FINISHES

Formica laminate finish: _____	
Other laminate finish (specify): _____	
Other custom lamiante specs:	
Brushed Stainless Steel	
Oak Veneer Plywood	
- Vertical grain direction	
- Horizontal grain direction	
Birch/Maple Veneer Plywood	
- Vertical grain direction	
- Horizontal grain direction	
Clear finish applied to veneer	
Stain finish Choice: _____	
1" black McCue impact bumper strip applied to the front of the display	
Other McCue impact bumper strip colors available upon request	

### END PANELS

Interior laminate the same as exterior	
Brushed Stainless Steel interior	
Mirrored interior	
Tempered glass end panels	
Mirrored glass panels	
1" black McCue impact bumper strip applied to the front of the display	
Other McCue impact bumper strip colors available upon request	

### MISCELLANEOUS

2 ½" H x 14"D Stepped riser	
Perforated inlay panel for canted display	
Roll-down thermal night curtain	
Heavy duty lockable casters	
Bolt-on top mounted dry shelving display	

## ADDITIONAL FEATURES:

- Designed to maintain the critical temperature of the products within the display at a range of 38-41°F (3-5°C) with an ambient atmosphere of 75°F (24°C)/55% humidity. Designed for holding pre-chilled product only
- Hot gas condensate evaporation system (most units)
- ETL listed and Sanitation certified to NSF-7
- 1 year parts and labor warranty

# SINGLE-LEVEL SELF-SERVICE DISPLAY - 42"H

## STANDARD FEATURES SHOWN

MRO-24-42



FINISHES:  
POWDERCOAT,  
TEXTURED BLACK

## CUSTOM FEATURES SHOWN



FINISHES:  
LAMINATE,  
BRAZILWOOD (7946)

MRO-38-42



FINISHES:  
POWDERCOAT,  
TEXTURED BLACK



FINISHES:  
LAMINATE,  
SOFT GOLD MESH (4911)

MRO-48-42



FINISHES:  
POWDERCOAT,  
TEXTURED BLACK



FINISHES:  
LAMINATE,  
PORT (D14)



# SINGLE-LEVEL SELF-SERVICE DISPLAY - 42"H

## STANDARD FEATURES SHOWN

## CUSTOM FEATURES SHOWN

MRO-57-42



FINISHES:  
POWDERCOAT,  
TEXTURED BLACK

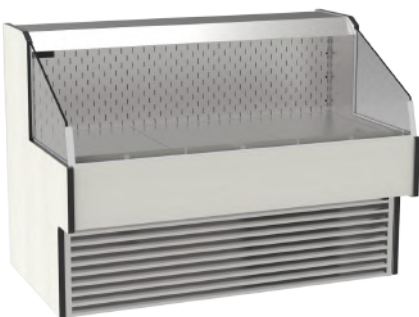

FINISHES:  
LAMINATE,  
VAPOR STRANDZ (4939K)

MRO-76-42



FINISHES:  
POWDERCOAT,  
TEXTURED BLACK



FINISHES:  
LAMINATE,  
SPROUT (4918)

MRO-96-42



FINISHES:  
POWDERCOAT,  
TEXTURED BLACK

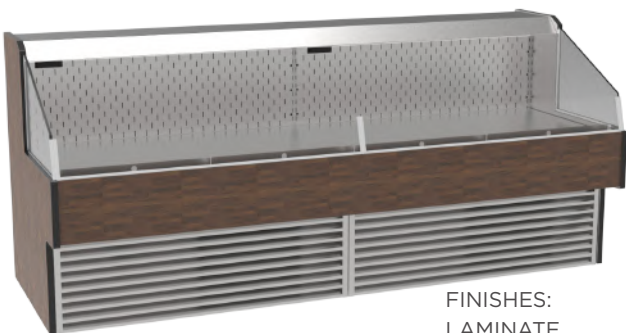

FINISHES:  
LAMINATE,  
OLD MILL OAK (7973K)

# TWO-LEVEL SELF-SERVICE DISPLAY - 49"H

 REFRIGERATED



Custom options available, refer to options schedule on next page.

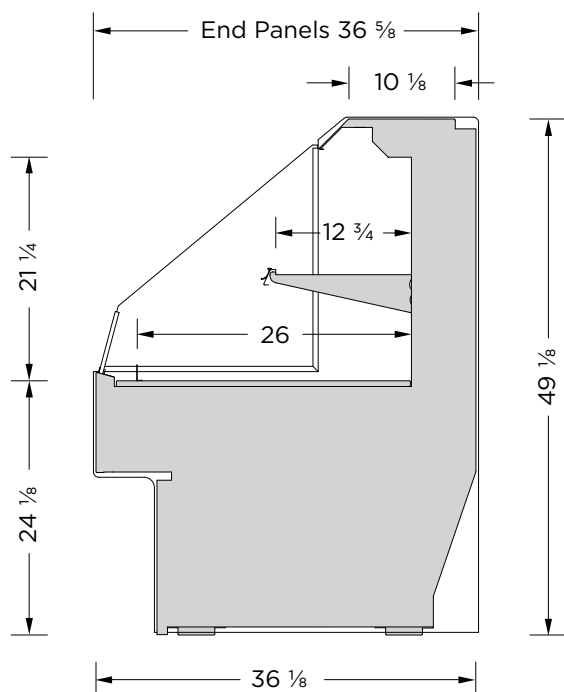

MODEL	LENGTH
MRO-24-49	26 1/4"
MRO-38-49	40 1/4"
MRO-48-49	49 7/8"
MRO-57-49	59 3/8"
MRO-76-49	78 1/2"
MRO-96-49	97 5/8"

## FEATURES:

- Brushed Stainless steel internal cabinet construction
- Many exterior finish options available: powdercoat paint, brushed stainless steel, laminates and natural wood finishes
- 3 interior finish options: textured powdercoat black, white and brushed stainless steel
- Other custom options are offered. Refer to the options schedule on the next page
- A LED light strip is mounted on the top ledge of the display area. Various light intensities/spectrums are available
- 1-12" adjustable metal shelf with integrated front product stop and LED light strip mounted to the bottom of the shelf
- Designed to maintain the critical temperature of the products within the display at a range of 38-41°F (3-5°C) with an ambient atmosphere of 75°F (24°C)/55% humidity
- ETL electrical certification and NSF-7 standards
- New R-513A (non-ozone depleting, low global warming potential) refrigerant used in the self-contained refrigeration system
- The refrigeration system is designed to pull fresh air from the front base of the display and vent through an integrated rear vent. The unique rear vent allows the display to be backed up against a wall or other displays/obstructions
- Remote refrigeration available. Contact Cayuga Displays for detail

## SUGGESTED APPLICATIONS:

 Cafe

 Restaurant

 Bakery

 Butcher Shop

 Deli

 Produce

Note: Information and specifications may change due to engineering improvements.



# TWO-LEVEL SELF-SERVICE DISPLAY - 49"H

REFRIGERATED

## TECHNICAL SPECS

MODEL	LENGTH	VOLTS	AMPS	NEMA PLUG
MRO-24-49	26 ¼"	115	11.8	5-15P
MRO-38-49	40 ¼"	115	11.9	5-15P
MRO-48-49	49 ⅞"	115	12.0	5-15P
MRO-57-49	59 ⅝"	115/230	9.3	L14-20P
MRO-76-49	78 ½"	115/230	12.1	L14-20P
MRO-96-49	97 ⅝"	115/230	12.5	L14-20P

## STANDARD FEATURES:

- 3 interior finishes options: textured powdercoat black, white and brushed stainless steel
- Black or white laminate exterior finish
- Solid end panels with black or white interior finish
- A LED light strip is mounted on the top ledge of the display area
- 1-12" adjustable metal shelf with integrated front product stop and LED light strip mounted to the bottom of the shelf
- The refrigeration system is designed to pull fresh air from the front base of the display and vent through an integrated rear vent. The unique rear vent allows the display to be backed up against a wall or other displays/obstructions

## CUSTOM FEATURES:

### EXTERIOR FINISHES

Formica laminate finish: _____	
Other laminate finish (specify): _____	
Other custom laminate specs:	
Brushed Stainless Steel	
Oak Veneer Plywood	
- Vertical grain direction	
- Horizontal grain direction	
Birch/Maple Veneer Plywood	
- Vertical grain direction	
- Horizontal grain direction	
Clear finish applied to veneer	
Stain finish Choice: _____	
1" black McCue impact bumper strip applied to the front of the display	
Other McCue impact bumper strip colors available upon request	

### END PANELS

Interior laminate the same as exterior	
Brushed Stainless Steel interior	
Mirrored interior	
Tempered glass end panels	
Mirrored glass panels	
1" black McCue impact bumper strip applied to the front of the display	
Other McCue impact bumper strip colors available upon request	

### MISCELLANEOUS

2 ½" H x 14"D Stepped riser	
Perforated inlay panel for canted display	
Price tag moulding attached to shelf	
Heavy duty lockable casters	
Bolt-on top mounted dry shelving display	

## ADDITIONAL FEATURES:

- Designed to maintain the critical temperature of the products within the display at a range of 38-41°F (3-5°C) with an ambient atmosphere of 75°F (24°C)/55% humidity. Designed for holding pre-chilled product only
- Hot gas condensate evaporation system (most units)
- ETL listed and Sanitation certified to NSF-7
- 1 year parts and labor warranty

# TWO-LEVEL SELF-SERVICE DISPLAY - 49"H

## STANDARD FEATURES SHOWN

## CUSTOM FEATURES SHOWN

### MRO-24-49



FINISHES:  
POWDERCOAT,  
TEXTURED BLACK



FINISHES:  
LAMINATE,  
BRAZILWOOD (7946)

### MRO-38-49



FINISHES:  
POWDERCOAT,  
TEXTURED BLACK



FINISHES:  
LAMINATE,  
SOFT GOLD MESH (4911)

### MRO-48-49



FINISHES:  
POWDERCOAT,  
TEXTURED BLACK



FINISHES:  
LAMINATE,  
PORT (D14)



# TWO-LEVEL SELF-SERVICE DISPLAY - 49”H

## STANDARD FEATURES SHOWN

## CUSTOM FEATURES SHOWN

MRO-57-49



FINISHES:  
POWDERCOAT,  
TEXTURED BLACK



FINISHES:  
LAMINATE,  
VAPOR STRANDZ (4939K)

MRO-76-49



FINISHES:  
POWDERCOAT,  
TEXTURED BLACK



FINISHES:  
LAMINATE,  
SPROUT (4918)

MRO-96-49



FINISHES:  
POWDERCOAT,  
TEXTURED BLACK



FINISHES:  
LAMINATE,  
OLD MILL OAK (7973K)

# THREE-LEVEL SELF-SERVICE DISPLAY - 54"H

 REFRIGERATED



*Custom options available, refer to options schedule on next page.*

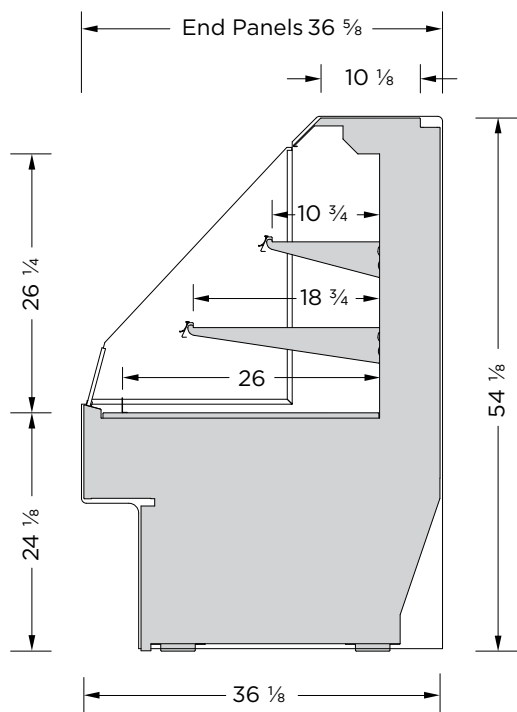

MODEL	LENGTH
MRO-24-54	26 $\frac{1}{4}$ "
MRO-38-54	40 $\frac{1}{4}$ "
MRO-48-54	49 $\frac{7}{8}$ "
MRO-57-54	59 $\frac{3}{8}$ "
MRO-76-54	78 $\frac{1}{2}$ "
MRO-96-54	97 $\frac{5}{8}$ "

## FEATURES:

- Brushed Stainless steel internal cabinet construction
- Many exterior finish options available: powdercoat paint, brushed stainless steel, laminates and natural wood finishes
- 3 interior finish options: textured powdercoat black, white and brushed stainless steel
- Other custom options are offered. Refer to the options schedule on the next page
- A LED light strip is mounted on the top ledge of the display area. Various light intensities/spectrums are available
- 1-12" & 1-18" adjustable metal shelves with integrated front product stop and LED light strip mounted to the bottom of the shelves
- Designed to maintain the critical temperature of the products within the display at a range of 38- 41°F (3-5°C) with an ambient atmosphere of 75°F (24°C)/55% humidity
- ETL electrical certification and NSF-7 standards
- New R-513A (non-ozone depleting, low global warming potential) refrigerant used in the self-contained refrigeration system
- The refrigeration system is designed to pull fresh air from the front base of the display and vent through an integrated rear vent. The unique rear vent allows the display to be backed up against a wall or other displays/obstructions
- Remote refrigeration available. Contact Cayuga Displays for details

## SUGGESTED APPLICATIONS:

 Cafe

 Bakery

 Deli

 Restaurant

 Butcher Shop

 Produce

Note: Information and specifications may change due to engineering improvements.



# THREE-LEVEL SELF-SERVICE DISPLAY - 54"H

REFRIGERATED

## TECHNICAL SPECS

MODEL	LENGTH	VOLTS	AMPS	NEMA PLUG
MRO-24-54	26 ¼"	115	11.8	5-15P
MRO-38-54	40 ¼"	115	11.9	5-15P
MRO-48-54	49 ⅞"	115	12.0	5-15P
MRO-57-54	59 ⅞"	115/230	9.8	L14-20P
MRO-76-54	78 ½"	115/230	12.6	L14-20P
MRO-96-54	97 ⅞"	115/230	13.0	L14-20P

## STANDARD FEATURES:

- 3 interior finishes options: textured powdercoat black, white and brushed stainless steel
- Black or white laminate exterior finish
- Solid end panels with black or white interior finish
- A LED light strip is mounted on the top ledge of the display area
- 1-12" & 1-18" adjustable metal shelves with integrated front product stop and LED light strip mounted to the bottom of the shelves
- The refrigeration system is designed to pull fresh air from the front base of the display and vent through an integrated rear vent. The unique rear vent allows the display to be backed up against a wall or other displays/obstructions

## CUSTOM FEATURES:

### EXTERIOR FINISHES

Formica laminate finish: _____	
Other laminate finish (specify): _____	
Other custom lamiante specs:	
Brushed Stainless Steel	
Oak Veneer Plywood	
- Vertical grain direction	
- Horizontal grain direction	
Birch/Maple Veneer Plywood	
- Vertical grain direction	
- Horizontal grain direction	
Clear finish applied to veneer	
Stain finish Choice: _____	
1" black McCue impact bumper strip applied to the front of the display	
Other McCue impact bumper strip colors available upon request	

### END PANELS

Interior laminate the same as exterior	
Brushed Stainless Steel interior	
Mirrored interior	
Tempered glass end panels	
Mirrored glass panels	
1" black McCue impact bumper strip applied to the front of the display	
Other McCue impact bumper strip colors available upon request	

### MISCELLANEOUS

2 ½" H x 14"D Stepped riser	
Perforated inlay panel for canted display	
Price tag moulding attached to shelf	
Heavy duty lockable casters	
Bolt-on top mounted dry shelving display	

## ADDITIONAL FEATURES:

- Designed to maintain the critical temperature of the products within the display at a range of 38-41°F (3-5°C) with an ambient atmosphere of 75°F (24°C)/55% humidity. Designed for holding pre-chilled product only
- Hot gas condensate evaporation system (most units)
- ETL listed and Sanitation certified to NSF-7
- 1 year parts and labor warranty

# THREE-LEVEL SELF-SERVICE DISPLAY - 54”H

## STANDARD FEATURES SHOWN

## CUSTOM FEATURES SHOWN

### MRO-24-54



FINISHES:  
POWDERCOAT,  
TEXTURED BLACK



FINISHES:  
LAMINATE,  
BRAZILWOOD (7946)

### MRO-38-54



FINISHES:  
POWDERCOAT,  
TEXTURED BLACK



FINISHES:  
LAMINATE,  
SOFT GOLD MESH (4911)

### MRO-48-54



FINISHES:  
POWDERCOAT,  
TEXTURED BLACK



FINISHES:  
LAMINATE,  
PORT (D14)



# THREE-LEVEL SELF-SERVICE DISPLAY - 54”H

## STANDARD FEATURES SHOWN

## CUSTOM FEATURES SHOWN

### MRO-57-54



FINISHES:  
POWDERCOAT,  
TEXTURED BLACK



FINISHES:  
LAMINATE,  
VAPOR STRANDZ (4939K)

### MRO-76-54



FINISHES:  
POWDERCOAT,  
TEXTURED BLACK

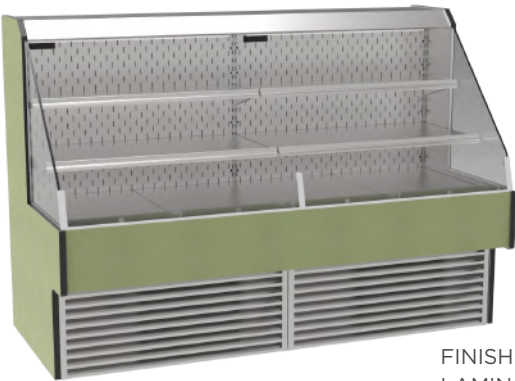

FINISHES:  
LAMINATE,  
SPROUT (4918)

### MRO-96-54



FINISHES:  
POWDERCOAT,  
TEXTURED BLACK

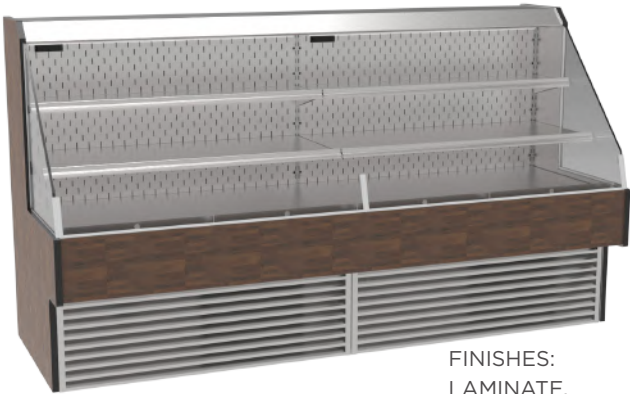

FINISHES:  
LAMINATE,  
OLD MILL OAK (7973K)

# REFRIGERATED DISPLAY ACCESSORIES

## 2 1/2" X 13" SINGLE STEP RISER

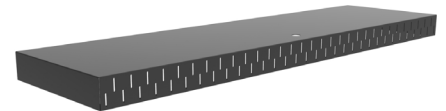
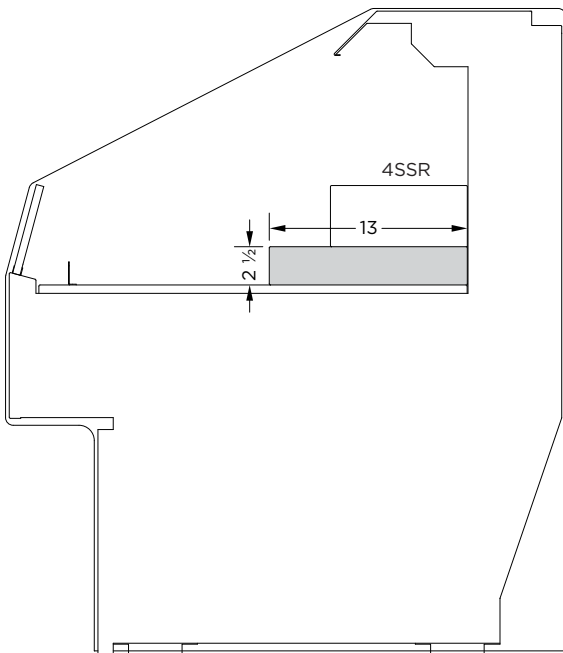

DISPLAY WIDTH	PART #	QTY
24"	2SSR-24-P*, S*	1
38"	2SSR-38-P, S	1
48"	2SSR-48-P, S	1
57"	2SSR-57-P, S	1
76"	2SSR-38-P, S	2
96"	2SSR-48-P, S	2

P = Painted powdercoat finish  
S = Brushed stainless steel

## 4" X 9" SINGLE STEP RISER

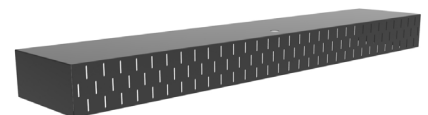
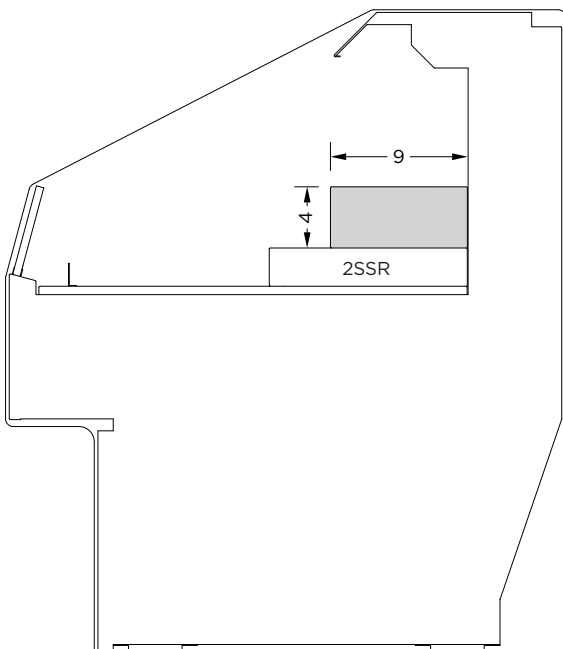

DISPLAY WIDTH	PART #	QTY
24"	4SSR-24-P*, S*	1
38"	4SSR-38-P, S	1
48"	4SSR-48-P, S	1
57"	4SSR-57-P, S	1
76"	4SSR-38-P, S	2
96"	4SSR-48-P, S	2

P = Painted powdercoat finish  
S = Brushed stainless steel

# REFRIGERATED DISPLAY ACCESSORIES

## THREE TIER STEPPED RISER

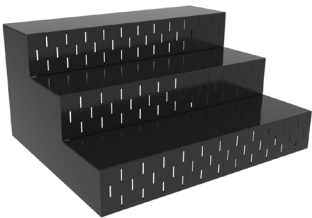
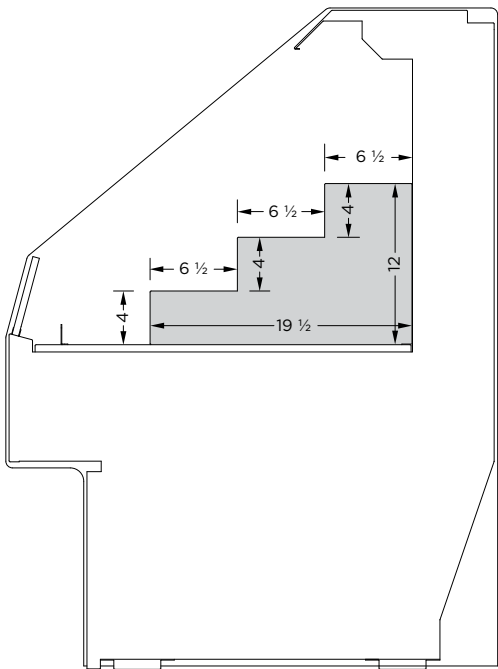

DISPLAY WIDTH	PART #	QTY
24"	3TSR-24-P*, S*	1
38"	3TSR-19-P, S	2
48"	3TSR-24-P, S	2
57"	3TSR-19-P, S	3
76"	3TSR-19-P, S	4
96"	3TSR-24-P, S	4

P = Painted powdercoat finish  
S = Brushed stainless steel

## FOUR TIER STEPPED RISER

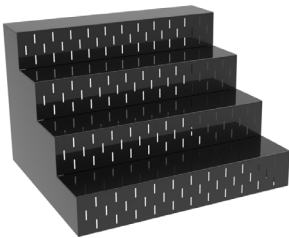
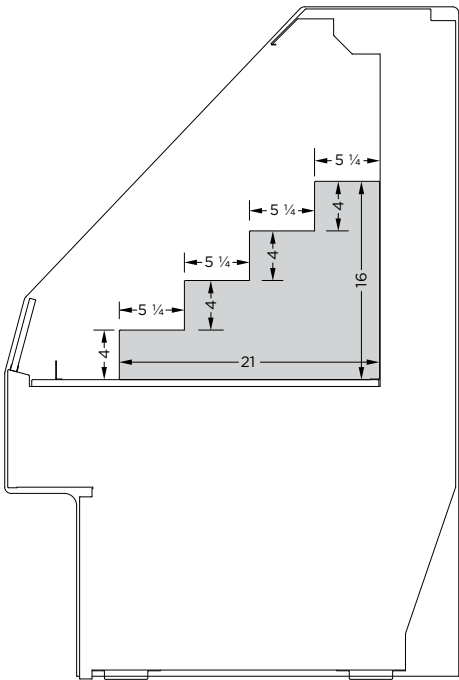

DISPLAY WIDTH	PART #	QTY
24"	4TSR-24-P*, S*	1
38"	4TSR-19-P, S	2
48"	4TSR-24-P, S	2
57"	4TSR-19-P, S	3
76"	4TSR-19-P, S	4
96"	4TSR-24-P, S	4

P = Painted powdercoat finish  
S = Brushed stainless steel

# REFRIGERATED DISPLAY ACCESSORIES

## CLIP-IN ANGLED BASE INLAY

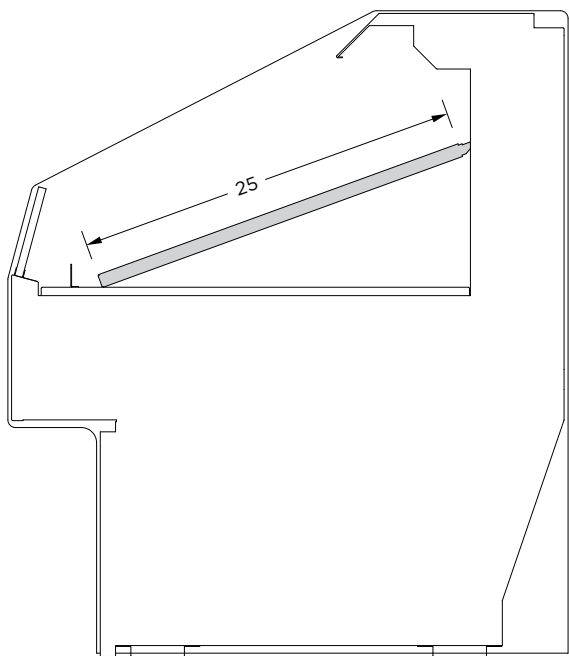

DISPLAY WIDTH	PART #	QTY
24"	ABI-24-P*, S*	1
38"	ABI-38-P, S	1
48"	ABI-48-P, S	1
57"	ABI-57-P, S	1
76"	ABI-38-P, S	2
96"	ABI-48-P, S	2

P = Painted powdercoat finish  
S = Brushed stainless steel

## TOP MOUNTED CLIP-ON DRY SHELF

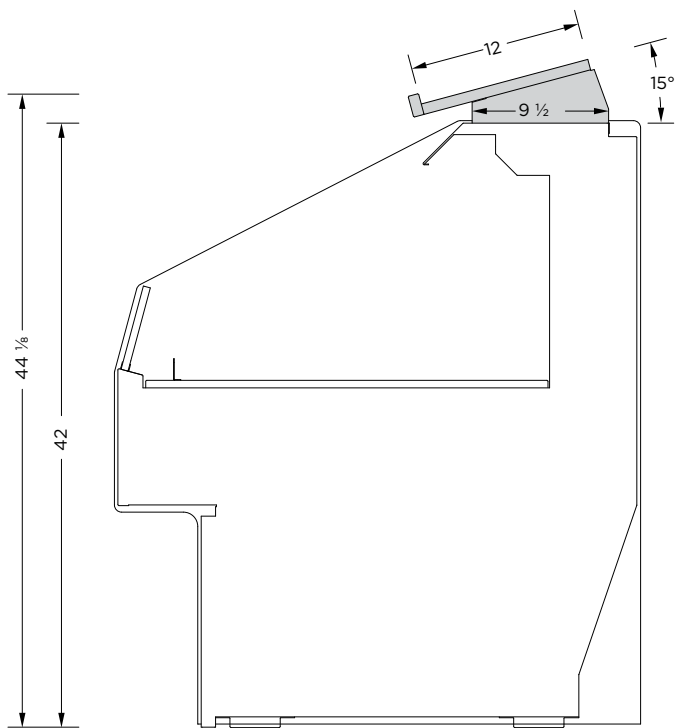

DISPLAY WIDTH	PART #
24"	CDS-24
38"	CDS-38
48"	CDS-48



# REFRIGERATED DISPLAY ACCESSORIES

## CLIP-ON SIGN PANEL

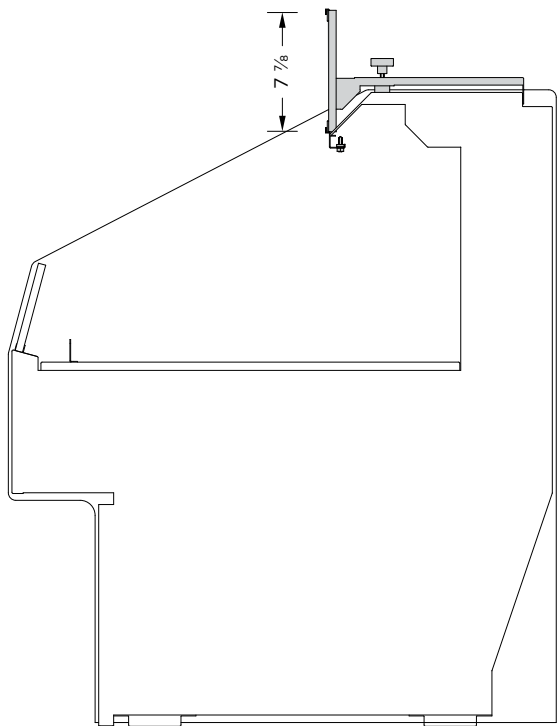

DISPLAY WIDTH	PART #
24"	CSP-24-P*, S*
38"	CSP-38-P, S
48"	CSP-48-P, S

P = Painted powdercoat finish  
S = Brushed stainless steel

### FEATURES:

- Plastic channels top & bottom to hold paper signs
- 3-track sign available

## RAISED TOP MOUNTED CLIP-ON DRY SHELF

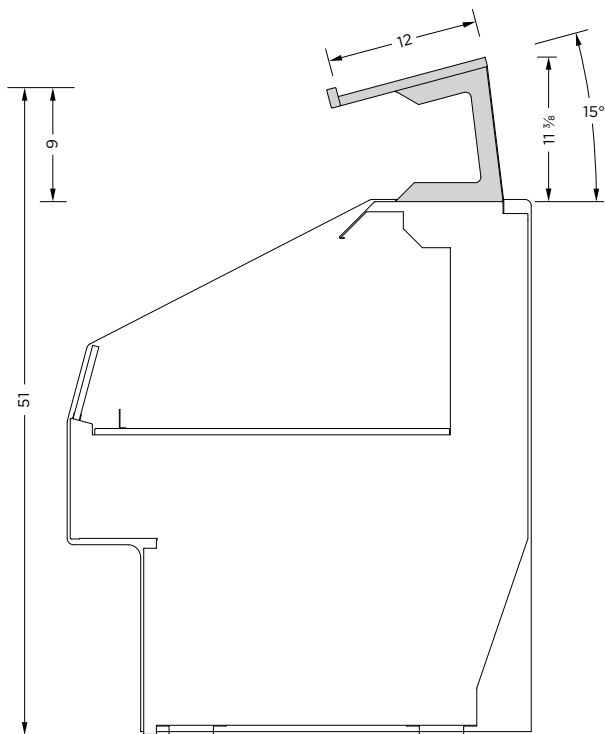

Model shown w/Clip-On Sign Panel & Raised Top Mounted Clip-On Dry Shelf



DISPLAY WIDTH	PART #
24"	RCDS-24
38"	RCDS-38
48"	RCDS-48

# NARROW MULTI-SHELF TABLE



MODEL	DESCRIPTION	LENGTH	DEPTH	HEIGHT
TBFS-002-01B	Multi-Shelf Table - 48"	47 1/2"	29"	55"
TBFS-002-02B	Multi-Shelf Table - 36"	35 1/2"	29"	55"

## FEATURES:

- Birch/maple plywood construction and solid maple trims
- 1-13" & 1-18" adjustable wood shelves with 3" front product stop (shelves can be canted) Heavy duty casters (2 locking)
- Open base merchandising area
- Adjustable bottom shelf
- 1 1/2" ABS bumper

## OPTIONS:

- Refer to Wood Stains Finishes

Note: Information and specifications may change due to engineering improvements.

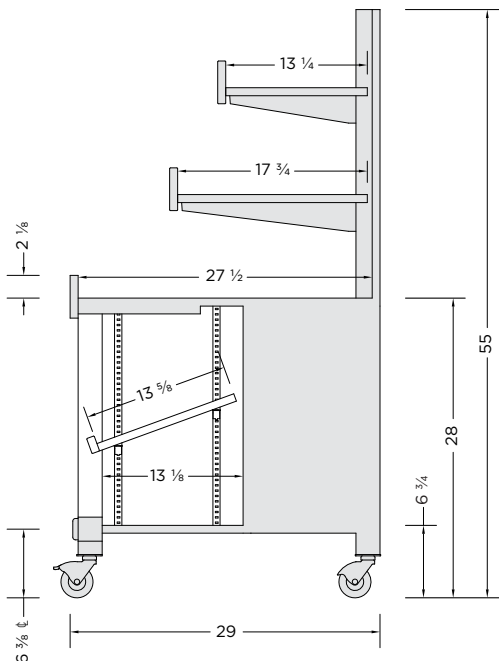

TBFS-002-01B (47 1/2"L) &  
TBFS-002-02B (35 1/2"L)

# ACCESSORIES

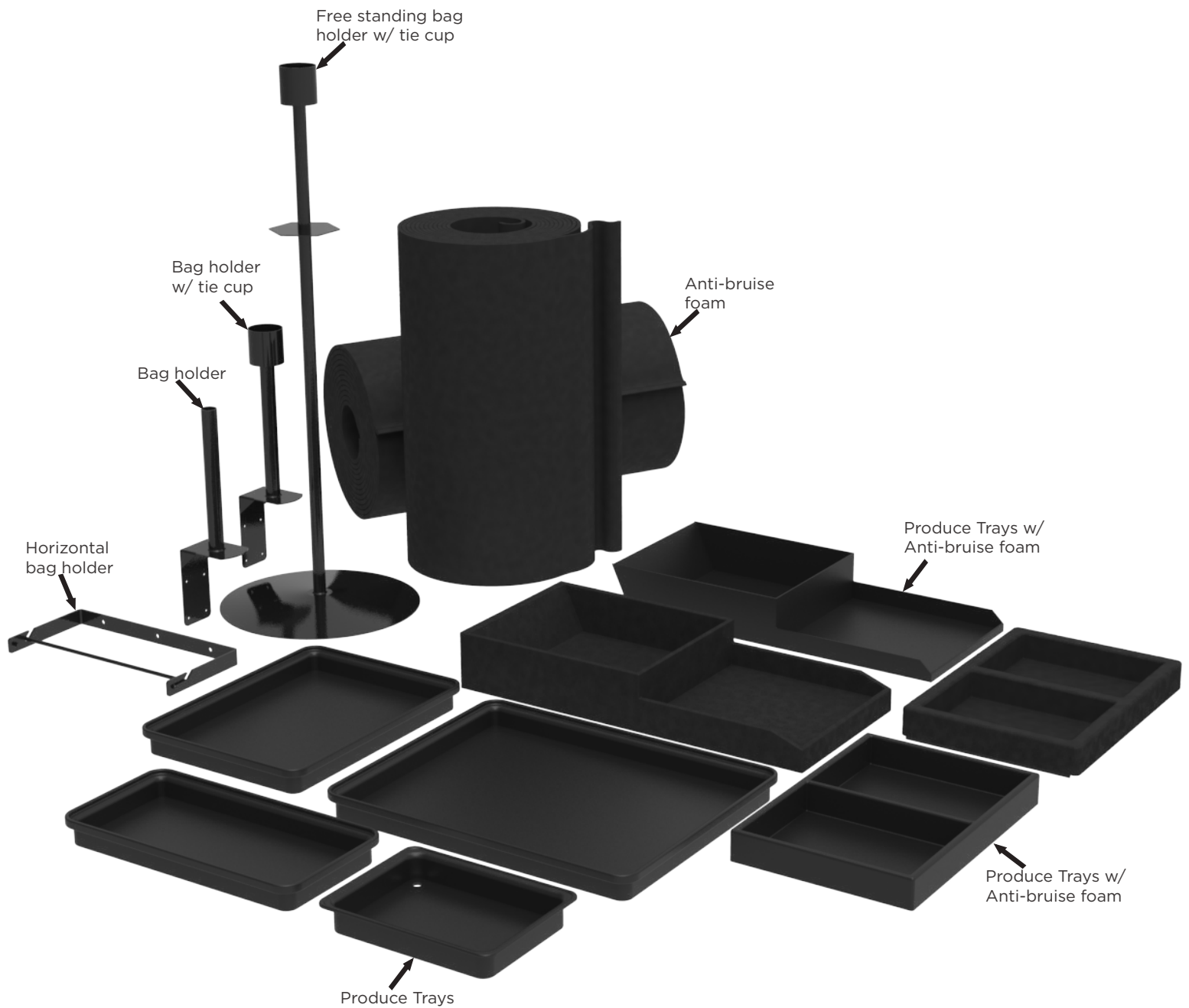

# BAG HOLDER

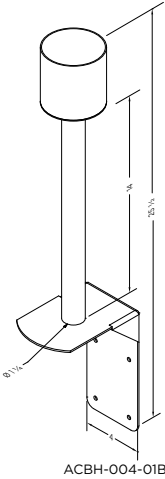
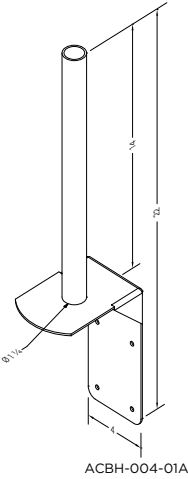
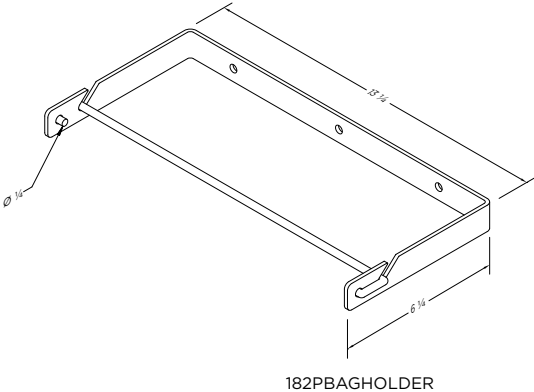
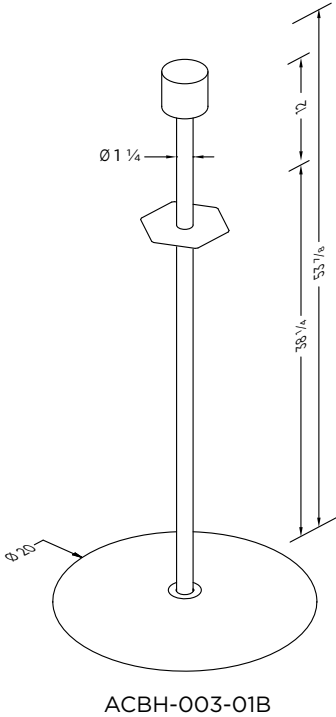
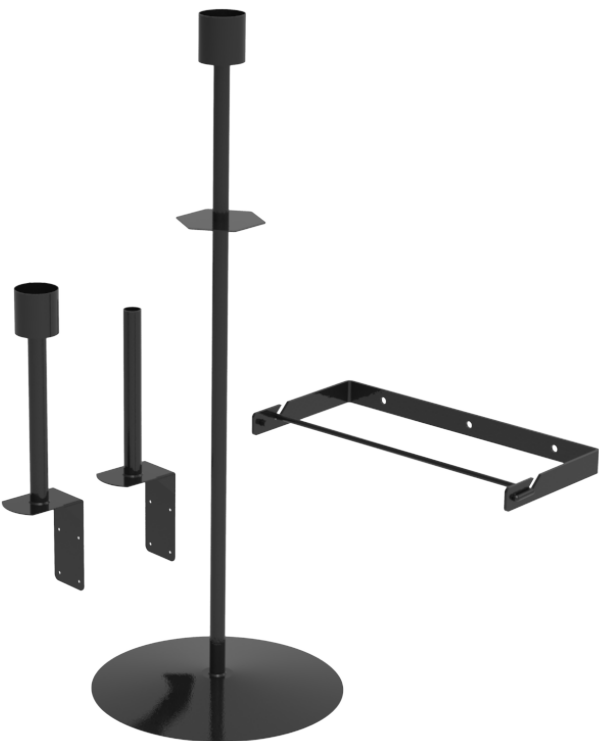

MODEL	DESCRIPTION	LENGTH	DEPTH	HEIGHT
182PBAGHOLDER	Horizontal Bag Holder	13 ¼"	6 ¼"	-
ACBH-003-01B	Free Standing Bag Holder w/ Tie Cup	20"Ø	-	50 ¼"
ACBH-004-01A	Screw On Bag Holder	4"	6"	22"
ACBH-004-01B	Screw On Bag Holder w/ Tie Cup	4"	6"	25 ½"

### FEATURES:

- Metal construction powder coated black

Note: Information and specifications may change due to engineering improvements.

# PRODUCE TRAY

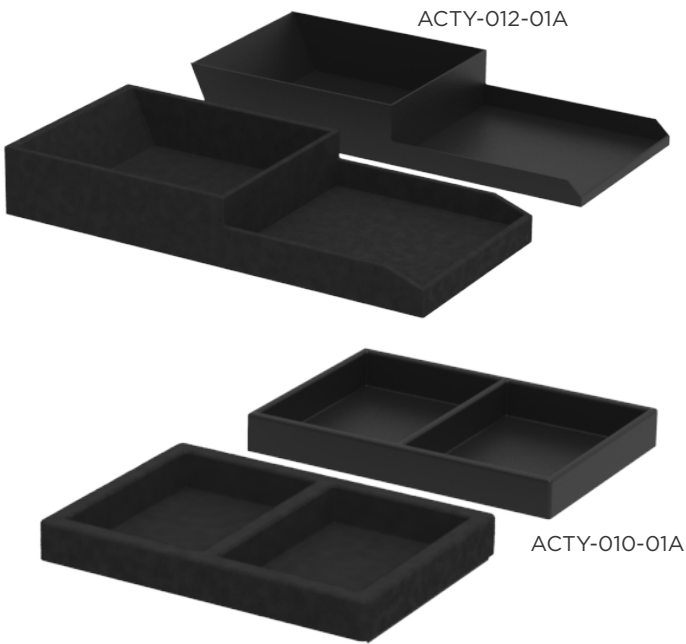

MODEL	DESCRIPTION	LENGTH	DEPTH	HEIGHT
ACTY-012-01A	Produce Tray - Two Tie	35 3/8"	15 3/4"	5 1/2"
ACTY-013-01A	Anti-bruise foam for ACTY-012-01A			
ACTY-010-01A	Produce Tray - Two Compartment	23 1/8"	16 1/4"	2 3/4"
ACTY-011-01A	Anti-bruise foam for ACTY-010-01A			

## FEATURES:

- Black ABS construction
- Black anti-bruise closed cell foam
- Trays designed to work with TBTS-005 tables

Note: Information and specifications may change due to engineering improvements.

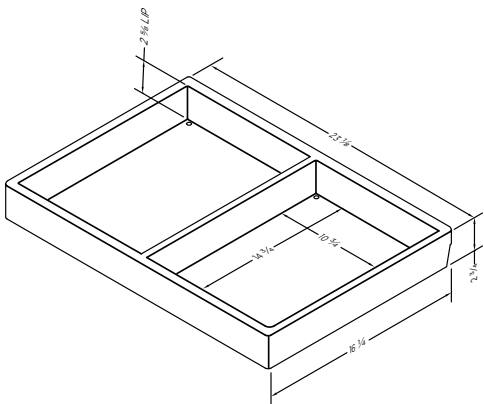

ACTY-010-01A

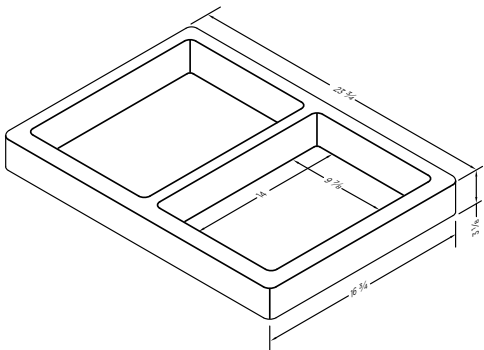

ACTY-011-01A

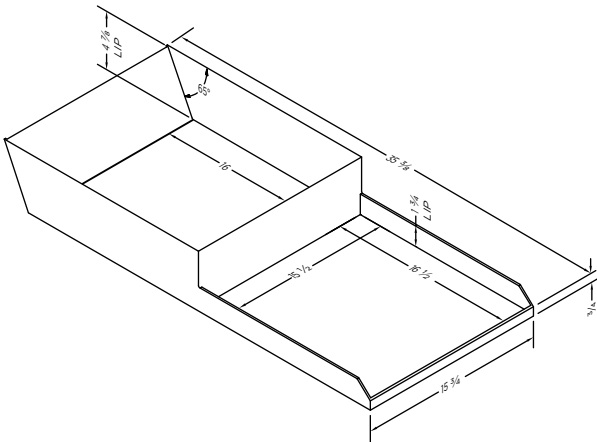

ACTY-012-01A

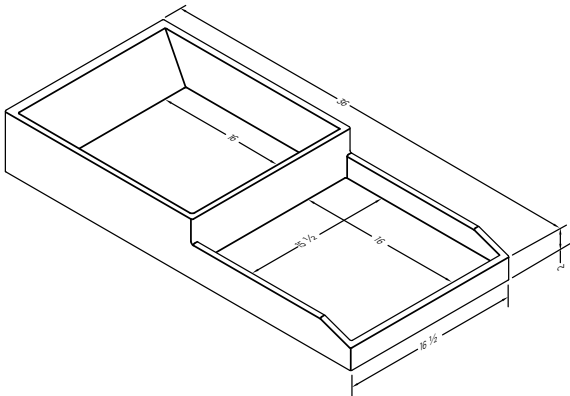

ACTY-013-01A



# PRODUCE TRAY WITH LIP



MODEL	DESCRIPTION	LENGTH	DEPTH	HEIGHT
ACTY-007-01A	Produce Tray -Lip	24"	30"	2 ½"
ACTY-008-01A	Produce Tray -Lip	24"	18"	2 ½"
ACTY-009-01A	Produce Tray -Lip	24"	12"	2 ½"
ACTY-014-01A	Produce Tray -Lip	16"	12"	2 ½"

- FEATURES:**
- Black ABS construction
  - Drainage holes
  - Min qty = 20

Note: Information and specifications may change due to engineering improvements.

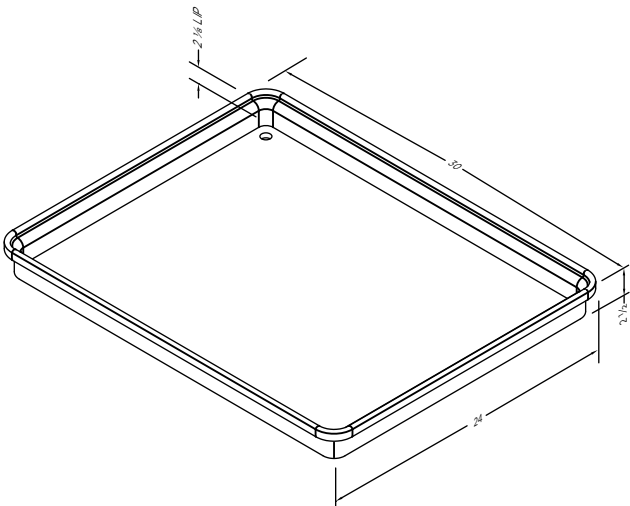

ACTY-007-01A

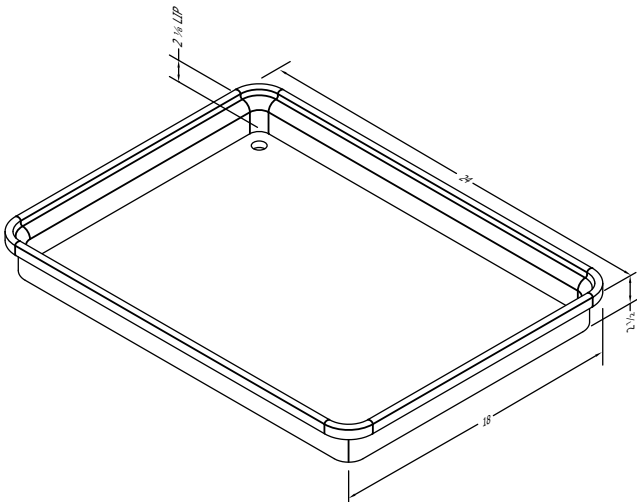

ACTY-008-01A

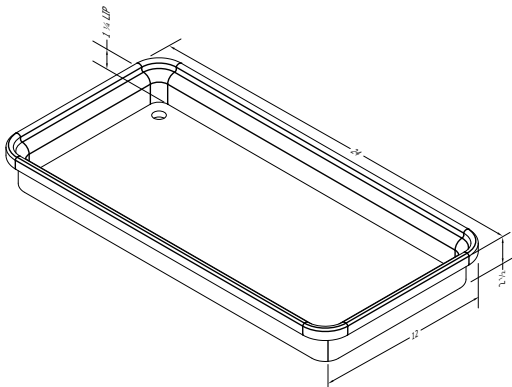

ACTY-009-01A

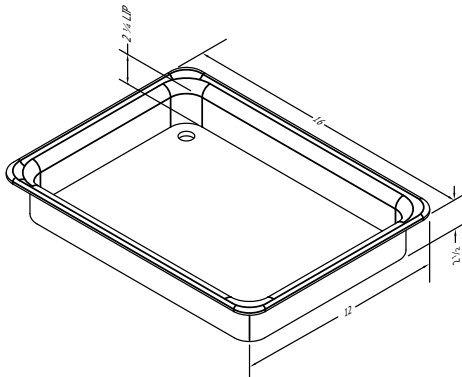

ACTY-014-01A

# ANTI-BRUISE FOAM MATTING - ROLL



MODEL	DESCRIPTION	LENGTH	DEPTH	HEIGHT
CCA-100	Anti-Bruise Foam Matting - Roll	200'	60"	3/8"

## FEATURES:

- 3/8" thick foam matting
- 200' roll

Note: Information and specifications may change due to engineering improvements.

# CLAMP ON SIGN FRAME

Clear finish shown



MODEL	DESCRIPTION	LENGTH	DEPTH	HEIGHT
ACSN-002-01B	Clamp On Sign Frame	36"	1 ½"	15 ¼"

## FEATURES:

- Solid maple construction
- Clamping mechanism to attach sign to rear tilting deck of table
- Sign frame is able to tilt allowing frame to sit vertical with floor
- 3 track Washington Poster
- Works with both 3' & 4' tilt-top table

## OPTIONS:

- Refer to Wood Stains Finishes

Note: Information and specifications may change due to engineering improvements.

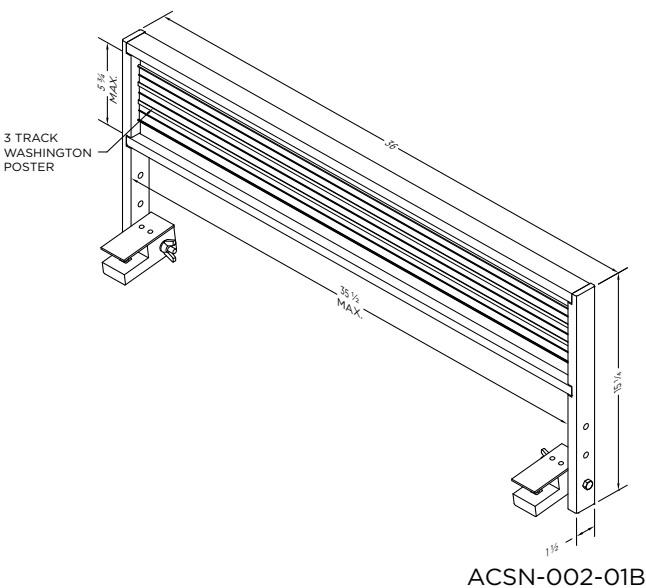



# THINGS TO CONSIDER

Showcases are designed to display your refrigerated products at 38-41°F (4-5°C). Showcases are designed to perform in environments of maximum 75°F (23°C) and 55% relative humidity.

**\*\*NOTE: FOR YOUR SHOWCASE TO FUNCTION AT PEAK EFFICIENCY YOU WILL NEED PROPER CLIMATE CONTROL AND AIR CIRCULATION\*\***

You need to consider the following when selecting a showcase and placing it in your store environment:

## 1 Consider nearby doorways and vestibules



A location near a doorway will negatively affect the airflow and holding temperature of both open and closed showcases.

## 2 Consider nearby windows



Direct sunlight will negatively affect the holding temperature of both open and closed showcases.

## 3 Consider nearby vent sources, hoods, cooking equipment and fans



HVAC ceiling vents, exhaust hoods, cooking equipment (steam heat) and ceiling fans will negatively affect the airflow of open showcases and will create condensation on the showcases if not properly managed.

## 4 Ensure your display is level and plumb



Ensure your showcase is plumb and level to allow for proper drainage of condensation water.

**Please note:** These are critical points to ensure the best results for your equipment and efficient space – and the best return on your investment!



# Regular Maintenance and Cleaning

Your showcase will work at its peak performance with regular maintenance. Refer to the Owner's Manual for maintenance and cleaning instructions.

To access the Owner's manual either visit us at [cayugadisplays.com/resources/manuals](https://cayugadisplays.com/resources/manuals) or access the QR code located on the electrical box of your case. You can also check out our online maintenance video.



Watch our maintenance videos at <https://cayugadisplays.com/resources/videos>

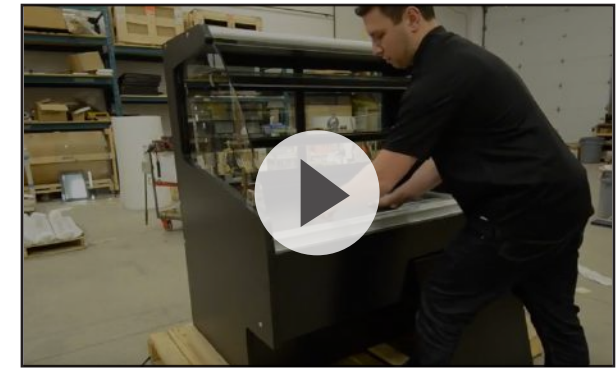

## 5 Leave appropriate space behind display



A 6" space is required behind any showcase that is against a wall or has a rear obstruction to allow for proper air flow around your showcase.

## 6 Clean your condenser grill and pre-filter



Use the included brush to regularly wipe away dust. Too much dust will not allow the refrigeration to work properly and could result in **expensive** damage.

**\*\*Refer to Owner's Manual for additional case cleaning checklist\*\***

## 7 ONLY PRE-CHILLED product in case



Refrigerated displays are designed to **KEEP COLD PRODUCT COLD** - they are not designed to bring warm products down to a cold temperature. For food safety it is always imperative that warm product be properly chilled (using a blast chiller or cold room) prior to storing in the refrigerated display case.

## 8 Noise

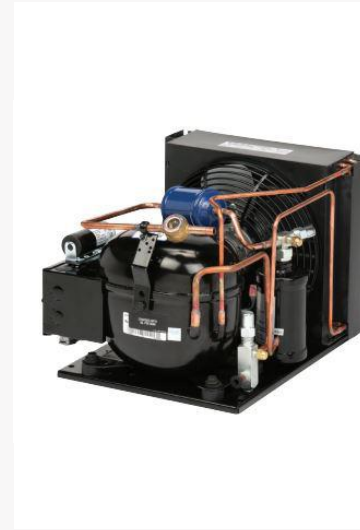

Self-contained cases have compressors, motors and fans and these will make noise. Keeping your showcase serviced and clean will help keep the noise level under control, improve lifespan, and maintain efficiency.

## 9 Condensation on closed and open cases



Condensation is caused by warm, moist air coming into contact with cool surfaces. If the case environment is not maintained below 75°F/23°C and 55% relative humidity, condensation may occur.

# TIPS TO COMBAT CONDENSATION

Showcases are designed to display your refrigerated products at 38-41°F (4-5°C). Showcases are designed to perform efficiently correctly when placed in environmental conditions of maximum 75°F (23°C) and 55% relative humidity.

**\*\*NOTE: FOR YOUR SHOWCASE TO FUNCTION AT PEAK EFFICIENCY YOU WILL NEED PROPER CLIMATE CONTROL AND AIR CIRCULATION\*\***

## 1 Condensation on closed and open cases



Condensation is caused by warm, moist air coming into contact with cool surfaces. If the case environment is not maintained below 75°F/23°C and 55% relative humidity, condensation may occur.

## 2 Consider nearby doorways and vestibules



A location near a doorway will affect the humidity that encounters your showcase which may cause condensation to occur.

- Relocate showcase away from doorways
- An air-conditioned vestibule will help to mitigate condensation

## 3 Consider nearby vent sources, hoods, cooking equipment and fans



HVAC ceiling vents, exhaust hoods, cooking equipment (steam heat) and ceiling fans will affect the airflow of open showcases and will create condensation on the showcases if not properly managed.

- Maintain environment below 75°F/23°C and 55% relative humidity
- Turn on air-conditioner and dehumidifier

**Please note:** These are critical points to ensure the best results for your equipment and efficient space – and the best return on your investment!



## Regular Maintenance and Cleaning

Your showcase will work at its peak performance with regular maintenance. Refer to the Owner's Manual for maintenance and cleaning instructions.

To access the Owner's manual either visit us at [cayugadisplays.com/resources/manuals](https://cayugadisplays.com/resources/manuals) or access the QR code located on the electrical box of your case. You can also check out our online maintenance video.



Watch our maintenance videos at <https://cayugadisplays.com/resources/videos>



### 4 Ambient humidity and temperature



Maintain environmental conditions during working and non-working store hours.

- Consider recirculating your conditioned air instead of bringing in fresh air from outside
- Turn on air-conditioner and dehumidifier
- Keep the A/C on even when it's cool outside as well as overnight
- Schedule regular maintenance for both A/C and dehumidifier as it frees parts and device of dirt, dust and other pollutants that can affect performance

### 5 Small store footprint



If your space is small, consider adding a dehumidifier.

- Install a dehumidifier with a floor drain to ensure humidity levels remain consistent
- Regular maintenance for dehumidifier is recommended (refer to manufacturers specifications)

### 6 Air circulation

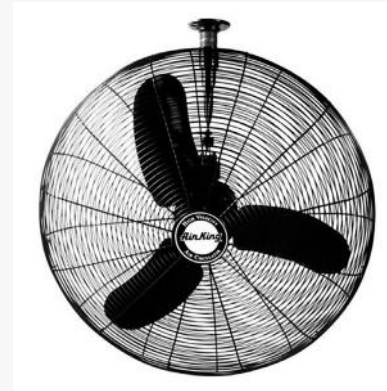

Ceiling fans help to mix dry air near the ceiling with cold moist air at ground level.

- Consider recirculating your conditioned air instead of bringing in fresh air from outside

### 7 Hot bars with steam wells



Both Soup wells and food bars that rely on steam to heat products produce steam that will raise the moisture levels

- Use dry heat wells
- Turn on dehumidifier to maintain 55% relative humidity



## Formica® Laminate

Formica Group provides surfaces that fuse beautiful design with purposeful functionality. Formica® Products provide versatile surfacing solutions that are inspired by and adapt to the way people live, work and play.

Formica® Brand Laminate offers a broader range of looks than ever before. Transform spaces with our modern laminates that are as beautiful as they are durable. Mix and match solids, patterns and finishes.

### Product Features:

- Postforming
- Durable and Wear-resistant
- Horizontal and Vertical
- Impact Resistant

## Formica® EliteForm

Our innovative Formica® EliteForm surfacing technology redefines the performance attributes of high pressure laminate to deliver a more durable laminate for today's market. Formica® Laminate with EliteForm features superior scratch resistance over other laminate brands, the ability to postform to a smaller radius with better blister resistance, and more durable, long-lasting surfaces, including the Gloss texture in horizontal applications. EliteForm comes standard on all Formica® Laminates, at no additional cost.

### Price Group One: All Colours are matte (-58) finish

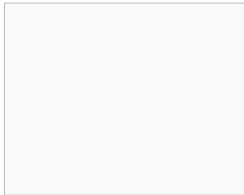

**949**  
White

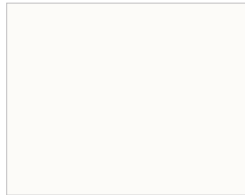

**7197**  
Dover White

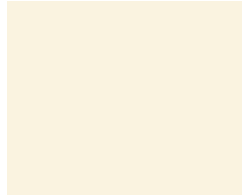

**920**  
Almond

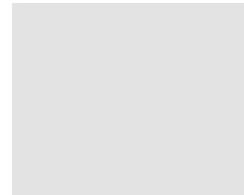

**927**  
Folkstone



**961**  
Fog



**845**  
Spectrum Red



**7897**  
Spectrum Green



**914**  
Marine Blue



**2297**  
Terril

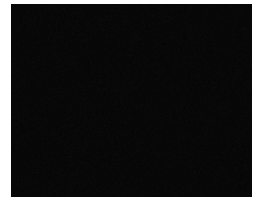

**909**  
Black



**6696**  
Carrara Bianco



**9476**  
White Ice Granite



**9497**  
Silver Quartzite



**7732**  
Butterum Granite



**9527**  
Black Shalestone



**8844**  
Aged Ash

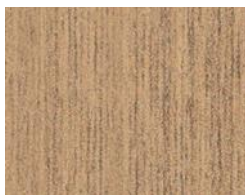

**5883**  
Pecan Woodline



**5884**  
Chestnut Woodline



**9283**  
Walnut Riftwood

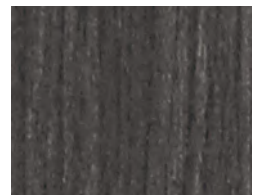

**6414**  
Black Riftwood



## Price Group Two: All Colours are matte finish

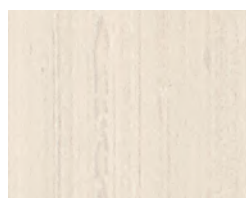

**6997**  
Pale Brushstroke



**6998**  
Wood Brushstroke



**7813**  
Cardboard Solidz



**9319**  
Stainless



**8918**  
Blackened Steel



**9310**  
White Marble Herringbone

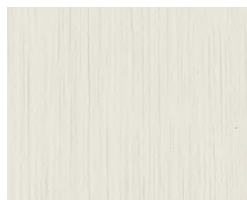

**9285**  
White Twill

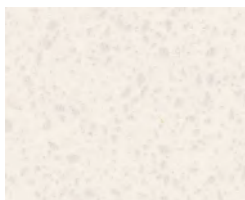

**6698**  
Paloma Pear



**503**  
Stone Grafix



**8830**  
Elemental Concrete

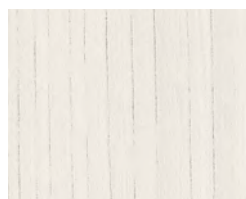

**8841**  
White Ash



**5785**  
Ashwood Beige

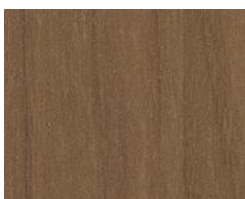

**5795**  
Camel Elm



**8845**  
Bleached Legno



**8916**  
Blackened Fiberwood

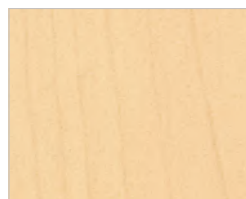

**86992**  
Hardrock Maple



**7012**  
Amber Maple



**8677**  
Scandi Rift Oak



**6995**  
Cherry Walnut



**7759**  
Select Cherry



Formica Canada Inc. is located in St-jean-sur-Richelieu, Quebec, and employs more than 250 people.

Formica Canada is proud to be part of the Well Made Here local purchasing program.

As the inventor of high pressure laminate, Formica Corporation has always worked to provide innovative, high quality products. Efficient use of resources is at our core, and we have taken many steps to improve our environmental footprint - from reusing the water in our presses to incorporating recycled materials into our surfacing products. We are committed to a long-term planning horizon that includes becoming an industry-leading environmental steward.



For larger laminate sample, please visit:  
[cayugadisplays.com](http://cayugadisplays.com) 1-800-839-5536  
[formica.com](http://formica.com) 1-800-FORMICA™



# PAINTED METAL

- **Standard products in stock**
- **RAL Program** colours not listed are also available upon request
- **Non-RAL Program** colours have long lead times and could affect deliver date

## CAYUGA STOCK COLOURS



Cayuga Black



Cayuga White

Cayuga black and white colours come in a textured finish.

Matte finish is available upon request.

## RAL STOCK COLOURS



Traffic Blue  
Ral 5017



Cream  
Ral 9001



Pure White  
Ral 9010



Traffic Orange  
Ral 2009



Pebble Grey  
Ral 7032



Basalt Grey  
Ral 7012



Traffic Grey  
Ral 7042



Quartz Grey  
Ral 7039



Traffic Red  
Ral 3020

# WOOD STAINS

## CAYUGA STANDARD WOOD GRAINS



**Oiled Cherry**

Match to Pionite/Panolam  
WC421 (Oiled Cherry)



**Wild Cherry**

Match to Formica 5904-43  
(Wild Cherry)



**Select Cherry**

Match to Formica 7759  
(Select Cherry)



**Choco Cherry**

Match to Panval/Uniboard  
207 (Choco Cherry)



**Natural Maple**

Match to Formica 86992-58  
(Hardrock Maple)



**Pearwood**

Match to Pionite/Panolam  
WX031 (Pearwood)

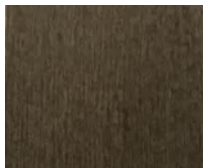

**Weathered Wood**

Match to Formica 8909-NF  
(Cascara Teakwood)



**Concerto**

Match to Arborite T485/  
Tafisa L485 (Concerto)

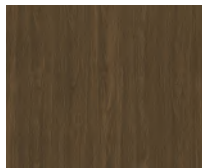

**Danish Walnut**

Match to Arborite W305  
(Parliament Walnut)



**Witchcraft**

Match to Pionite/Panolam  
WX421 (Witchcraft)



**Iron Mountain**

Match to Formica 912-58  
(Storm)

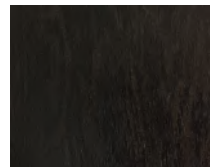

**Baloil**

Match to Formica 6414 NG  
(Black Riftwood)

\*Refer to physical swatches for a true representation of colors, above images may appear slightly different than actual samples.\*

# HOW TO ORDER

We'll help you select the right case for your requirements.  
The steps below will help us to serve you best.

- 1 Choose the showcase that meets your display requirements from the product specification sheets.
- 2 Review the options table found on the specification sheet and make your selections of the options provided.
- 3 Select from the large pallet of colours found on the last five pages of the brochure, or choose a stainless steel, standard black or white for the exterior finish of your showcase.
- 4 E-mail your request for a quote to your Cayuga sales representative or [sales@cayugadisplays.com](mailto:sales@cayugadisplays.com) and we will quickly respond to your request. Please include your full contact information in case we have any questions.

**Contact the inside sales team**

**Cayuga Displays**

E: [sales@cayugadisplays.com](mailto:sales@cayugadisplays.com)

T: 1-800-839-5536



**T:** 800.839.5536

**E:** [sales@cayugadisplays.com](mailto:sales@cayugadisplays.com)

**A:** 70 Talbot St E, PO Box 130  
Cayuga, ON N0A 1E0

